



CONSULTING ARBORISTS — URBAN FORESTRY SPECIALISTS

PHONE: 352-588-2580 FAX: 352-588-2229

P.O. Box 564 San Antonio, Fl. 33576

December 9, 2021

Mr. John Fitzgibbon/Mr. Robert Smith
Town of Windermere
614 Main St.
Windermere, Fl. 34786

Re: Ward Trail

Dear John and Robert:

Per the request of the Town of Windermere, I have completed my reconnaissance of the proposed Ward Trail right-of-way. The purpose of the reconnaissance and report is to identify trees affected by the trail which are to remain and to propose mitigation efforts to minimize the construction impact.

The proposed trail is aligned parallel to Main Street. The northern terminus is Park Avenue and the southern terminus is North Blvd., a distance of approximately .6 miles. The trail is a re-alignment of the existing sidewalk/trail. The proposed trail is paved and ten feet in width.

The reconnaissance of the proposed right-of-way revealed a total of 154 individual trees or small groups of trees (2-4 trees together) which were identified, assessed, and measured for diameter. Of these, a total of 45 trees or groups of trees are shown as being removed due to their location within the right-of-way or in such close proximity to be infeasible to remain. One tree, a 26 inch diameter longleaf pine (#117), is shown as falling within the path of a connector to the trail from the west off S. Lake Butler Boulevard.

The following species and numbers of each are being removed. This number includes the total number of each species, whether individually identified or within a group of mixed species. These groups are identified as such in the data table included herein.

Baldcypress: 1
Cabbage Palm: 1
Chinaberry: 1
Coontie: 3
Drake Elm: 3
Goldenrain: 1
Laurel oak: 15
Live oak: 11
Longleaf pine: 3 or 4 (see comment above)
Slash pine: 11
Water locusts: 2



CONSULTING ARBORISTS — URBAN FORESTRY SPECIALISTS

PHONE: 352-588-2580 FAX: 352-588-2229

P.O. Box 564 San Antonio, Fl. 33576

Root Protection

The biggest challenge regarding impact to the trees is root protection. Nine trees were identified as having surface roots extending into the new trail R-O-W. These are identified as trees 13, 14, 19, 20 near the south end of the trail and 67, 76, 78, 79, and 87 in the central portion of the length of the trail. These trees are identified as six live oaks with diameters ranging from 17 to 27 inches in diameter; two laurel oak are 10 inches and 20 inches; and a golden tabebuia four inches in diameter. All but trees 78 and 79 (both laurel oaks) are within three to six feet of the proposed trail; therefore, root pruning is not an option. The laurel oaks are approximately 12 feet from the trail and could be root pruned. Ideally, the root pruning should occur approximately 30 to 60 days prior to construction.

In addition, 36 other trees are recommended for some type of root protection or root pruning. Root pruning should only be done to trees which exceed 10 feet from the proposed trail or no less than six feet for trees less than ten inches in diameter. Where root pruning is not an option, for example, trees within a few feet of the trail, root protection measures, such as porous pavement or utilizing a gravel base under the trail is strongly recommended.

Tree Removal

Twenty trees are suggested for removal which are indicated as trees to remain. This recommendation is indicated in red on the data sheets. Reasons for removal vary from poor structure due to pruning for overhead utility lines, trees in poor condition due to decay, proximity to the new trail, or invasiveness. The latter includes # 55 and #73 (camphor), #89 (golden rain), #90 (golden rain – two trees), #119 (Chinaberry), # 138 and #154 (Chinese tallow). These species are recognized as either Category I or Category II invasive species by the Florida Exotic Pest Plant Council as disruptive to native ecosystems.

Tree #117

This is a 26 inch diameter longleaf pine near S. Lake Butler Boulevard just north of the wooded area north of the creek. This tree is shown as remaining on the site plan but is within the path of a spur connecting S. Lake Butler Boulevard to the new trail. Because of the size, location, and good condition of the tree, it is recommended that this connecting spur be relocated to avoid removal or serious root damage.

Other Trees

The inventory included herein is not a complete listing of all of the trees along the trail but represent those trees within the path or within approximately 10 to 12 feet of either side of the proposed trail. Therefore, even with the removal of approximately 45 – 55 trees for trail construction and another twenty trees for removal due to the reasons stated above, an additional 160 (approximately) trees are shown to remain along both sides of the trail.



CONSULTING ARBORISTS — URBAN FORESTRY SPECIALISTS

PHONE: 352-588-2580 FAX: 352-588-2229

P.O. Box 564 San Antonio, Fl. 33576

I hope this information is of assistance. Please feel free to call me at 863-670-0734 or email me at erich@nrpsforesters.com if you have any questions or need further assistance. Thank you for allowing Legacy Arborist Services to provide this service for you.

Sincerely,

Eric H. Hoyer
Certified Arborist #SO-0103
Registered Consulting Arborist #482

Tree Data Summary - Ward Trail

Tree #	Species	Diam.	In R-O-W	Remain	Dist. From Trail (ft.)	Observations/recommendations
1	Coontie	N/A	x			
2	Coontie	N/A	?			Not on survey
3	Drake elm	8	X			
4	Coontie	N/A	x			
5	Live oak	17		x	5	trunk wound at 4'; root protection needed
6	Live oak	22		x	4	root protection
7	Drake elm	6	x			
8	Drake elm	5		x		possible removal; leaning to south
9	Live oak	12		x	6	possible removal - trimmed for powerlines; poor structure
10	Live oak	29		x	4	previously pruned for powerline; root prune or bridge
11	Live oak	24		x	4	previously pruned for powerline; root prune or bridge
12	Live oak	16		x	4	root protection
13	Live oak	17		x	4	surface roots into trail; growing into lines; possible removal
14	Live oak	17		x	4	surface roots into trail; poor structure; possible removal
15	Drake elm	3	x			
16	Golden tabebuia	5		x	5	
17	So. Magnolia	5/7/9		x	6-7	3 trunks; under powerline; possible removal
18	So. Magnolia	10		x	7-8	under powerline; possible removal
19	Live oak	25		x	4	extensive surface roots into trail; root protection
20	Live oak	21		x	3	surface roots into trail; root protection
21	Live oak	17		x	12	root prune
22	Live oak	14		x	5	severely pruned for powerlines; possible removal
23	Live oak	17		x	4	root protection
24	Slash pine	10		x	3-4	root protection
25	Slash pine	9		x	3-4	root protection
26	Slash pine	8		x	3-4	root protection
27	Live oak	11		x	3-4	pruned for powerlines; root protection
28	Laurel oak	27		x	12	severely pruned for powerlines; possible removal
29	crepe myrtle	12		x	12	growing under oak canopies
30	crepe myrtle	12		x	12	growing under oak canopies
31	Florida elm	5		x	8	
32	Florida elm	6		x	8	
33	crepe myrtle	15		x	12	
34	Laurel oak	8		x	12-14	root prune
35	Live oak	16		x	10	root prune
36	Laurel oak	14		x	1-2	along trail access leg; possible removal
37	Live oak	23	x			
38	Live oak	18/13	x			along creek
39, 39a	Live oak, Sl. Pine	8/14	x			grouped together on survey; just north of creek
40	Live oak	20		x	3	poor structure; root protection
41	Slash pine	12/10/8	x			one pine; two water locusts
42	Slash pine	12	x			
43	Slash pine	16	x			

44-47	Slash pines	11-15	x			
48	Bay	7		x	10	
49	Live oak	16	x			
50	Laurel oak	12		x	10-12	root prune
51	Live oak	9	x			
52	Slash pine	16	x			
53	Red maple	9		x	15	poor structure
54	Laurel oak	12		x	10-12	possible root prune
55	Camphor	20		x	10-12	invasive species; remove
56	Miscellaneous	?		x	12-15	crepe myrtle, redmaple, slash pines
57	Laurel oak	10/12/18	x			3 trees
58	Norfolk pine	18		x	8	
59	Citrus	11		x	6	
60	Hickory	6		x	8	co-dominant
61	Longleaf pine	8		x	8	
62	Waxmyrtle	18		x	4	multiple stems; root prune
63	Cabbage palm	20	x			
64	Redcedar	4		x	5	
65	Golden tabebuia	4		x	5	
66	Hickory	4		x	3	root prune
67	Golden tabebuia	4		x	6	roots in trail r-o-w; root prune
68	So. Magnolia	5		x	3-4'	two trees approx 10' apart
69	Longleaf pine	6		x	5-6'	
70	Longleaf pine	6		x	5-6'	
71	Longleaf pine	7	x		2-3'	
72	Laurel oak	6	x			
73	Camphor	15		x	2-3'	invasive species; broken limbs; sprouts; remove
74	Laurel oak	20		x	10'	root damage; possible removal
75	Laurel oak	6		x	4'	small canopy
76	Live oak	25		x	6'	surface roots within new trail; root protection needed
77	Live oak	24	x			within trail; re-align trail to avoid tree
78	Laurel oak	20		x	12-14'	surface roots within new trail; root prune
79	Laurel oak	10		x	10-12'	surface roots; root prune; will be closer with re-alignment
80	Laurel oak	18		x	15'	root prune; will be closer with new alignment
81	Slash pine	13		x	20'	will be closer with new alignment
82	Slash pine	15	x			
83	Live oak	19		x	10'	will be closer with new alignment
84	Slash pine	15			10-12'	
85	Slash pine	12	x			
86	Slash pine	15	x		1-2'	edge of trail
87	Live oak	27		x	4-5'	root protection; surface roots within trail
88	Live oak	15			4-5'	root protection
89	Golden rain	9	x			invasive species
90	Golden rain	6/7		x	2'	two trees; invasive; edge of trail; remove
91	Laurel oak	30		x	8'	root protection/pruning
92	Live oak	10		x	6-8'	
93	Live oak	14		x	3'	root protection

94	Laurel oak	12	x			
95	Laurel oak	7		x	2-3'	root pruning; possible removal due to proximity
96	Laurel oak	12		x	8'	root pruning
97	Water oak	6		x	7	
98	Laurel oak	18		x	8-10'	root pruning
99	Laurel oak	10		x	10'	
100	Live oak	9		x	10'	
101	Longleaf pine	6-12		x	7-8'	four trees
102	Laurel oak	8		x	7-8'	leaning over trail; remove
103	Laurel oak	24		x	12'	root prune
104	Laurel oak	17		x	12'	root prune
105	Laurel oak	14		x	8'	root prune
106	Laurel oak	14		x	9'	root prune
107	Longleaf pine	11		x	6'	
108	Laurel oak	19		x	5'	root prune
109	Longleaf pine	11		x	3'	root protection
110	Laurel oak	11		x	8'	
111	Baldcypress	14	x			
112	Baldcypress	14		x	edge of trail	root protection or possible removal due to proximity
113	Baldcypress	11		x	edge of trail	root protection or possible removal due to proximity
114	Baldcypress	18		x	3'	root protection
115	Baldcypress	15		x	edge of trail	root protection or possible removal due to proximity
116	Baldcypress	12		x	8'	
117	Longleaf pine	26	?			connector to trail through tree
118	Longleaf pine	23		x	8'	8' from connector to trail
119	Chinaberry	4-10	x			invasive; within trail
120	Laurel oak	6		x	6'	leaning toward Main St.
121	Laurel oak	16	x			
122	Laurel oak	6		x	5'	
123	Longleaf pine	6/7/6			8-10'	three trees
124	Laurel/live oak	5-7	x			cluster of 6-7 oaks
125	Longleaf pine	19	x			
126	Longleaf pine	11	x			
127	Longleaf pine	13/8			15'	two trees
128	Live oak	8		x	13'	
129	Live oak	6/11/5	x			three trees
130	Laurel oak	13		x	5'	root prune
131	Laurel/live oak	4/5/6/8			3-8'	four trees
132	Laurel oak	15	x			
133	Laurel oak	8-18	x			4 trees; 5 trunks
134	Laurel oak	17/10	x			2 trunks
135	Live oak	16	x			
136	Laurel oak	15	x			
137	Laurel oak	10-14	x			5 trees; 6 trunks
138	Chinese tallow	9		x	6'	invasive' remove
139	Laurel oak	16/14	x			2 trees
140	Live oak	6		x	5-6'	

141	Laurel/live oak	9/9	x			
142	Laurel oak	6		x	8'	leaning over trail; poor condition; remove
143	Black cherry	6			6'	poor condition; remove
144	Live/laurel oak/	5/10/13	x			
	Black cherry					
145	Laurel oak	9		x	3'	root protection
146	Laurel oak	10/10	x			2 trees
147	Black cherry	6		x	3'	major trunk wound; remove
148	Laurel oak	10/8	x			two trees; leaning into trail
149	Laurel oak	9		x	10'	
150	Laurel oak	9/6/7		x	11'	3 trunks
151	Laurel oak	8		x	10'	
152	Black cherry	10		x	10'	
153	Laurel oak	8/23	x			2 trees
154	Chinese tallow	6		x	12'	Invasive; remove

BEGIN PROPOSED PROFILE
CONST. WARD TRAIL
STA 100+03.18 EL. 107.31

LEGEND
— SEDIMENT BARRIER

LEGEND
— INLET PROTECTION
— SEDIMENT BARRIER
— FLOATING TURBIDITY BARRIER

DATE	DESCRIPTION	REVISIONS	DATE	DESCRIPTION
9/17/2021	6:06:16 PM	Dr. Bault		
<p>Kimley-Horn Registered Professional Engineer Victor H. Gallo, P.E. License No. 75592 180 S. Orange Ave., Suite 1000 Orlando, FL 32801</p>				
<p>TOWN OF WINDERMERE K:\001_Roadway\04801007_Windermere_Ward_Trail_TPO\03_Roadway\04801007_V roadway Erosion Control Sheets\WINDERMERE.dgn</p>				
EROSION CONTROL (01)				SHEET NO.
				54

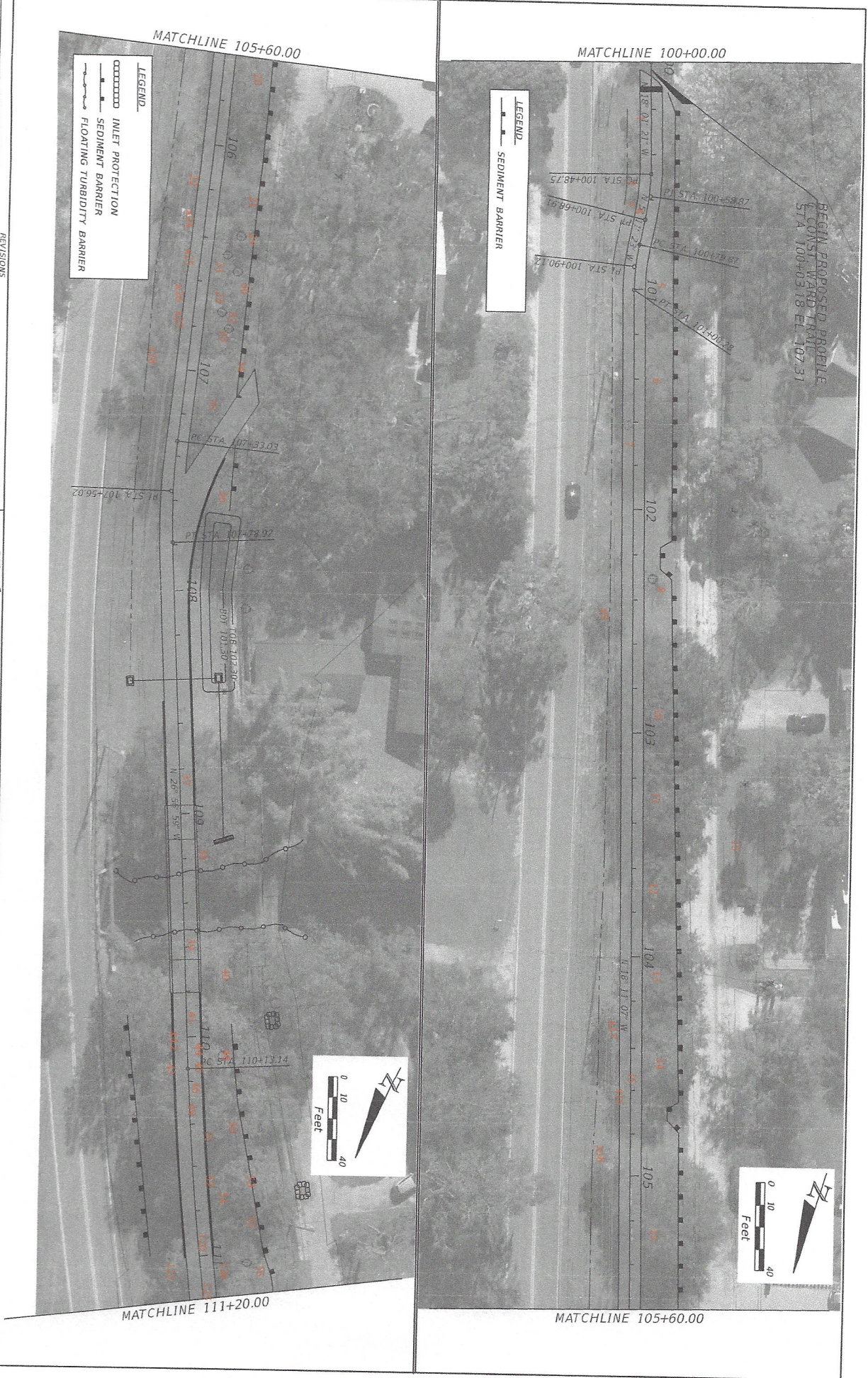



DATE		REVISIONS		DESCRIPTION	DATE	DESCRIPTION
DATE	DESCRIPTION	DATE	DESCRIPTION			
9/17/2021	6:06:30 PM					

Kimley-Horn

Registry No. 696
Victor H. Gallo, P.E.
P.C. License No. 75592
189 S. Orange Ave., Suite 1000
Orlando, FL 32801



roadway design

EROSION CONTROL (02)

SHEET NO. 55

K:\001_Roadway\04901807_Wintermead Trail\TPO\03_Roadway\04901807_Roadway Erosion Control Sheets\1A1802.dgn

