

**WINDERMERE PARKS & RECREATION COMMITTEE**  
**May 13, 2021 AGENDA**

---

*In order to maintain a 1hour time schedule, the committee will address the monthly agenda items only unless time remains for New Business discussion at the end. Agenda items should always be submitted in advance for committee consideration.*

1. OPEN FORUM/PUBLIC COMMENT (3 Minute Limit):

2. OLD BUSINESS:

a. Events:

i. Windermere Pet Fest

1. Approve event date of Saturday, March 5, 2022

ii. 19th Annual UMC Run Among the Lakes

1. Race date October 16, 2021
2. Need subcommittee for race

iii. Halloween Costume Parade and Hayride Saturday, October 30, 2021

b. Tennis

i. Tennis

1. Report from Tennis Subcommittee (Doug, Tracy, Sherry, Dena)
2. Self locking gates – See attached photos
3. Waiting on final proposal to determine & schedule resurfacing
  - Varsity Court - \$10,837
  - Nidy Sports - \$15,994
  - Sport Surfaces - \$19,200

c. Parks

1. Central Park

- Trees installed 4/30 – a few missing, scheduled by end of May
- Thanks to Tree Board for a great partnership

2. WRC

- Playground Equipment
  - Proposal from Swartz attached - \$28,399.47
  - Fencing?
  - Other playground equipment? See quote from Kompan
- Pickleball –
  - Quote from Varsity Courts - \$19,737 (question about levelling?)
  - Nidy Sports - \$48,565
  - Sport Surfaces - \$39,600

- Kayak Launcher –
  - Kayak/Canoe storage – 15 feet long X 6 feet deep X 7 feet tall – 18 canoes
  - Paver Walkway to Tennis Courts –
    - Total Brick Pavers -\$3,854.00
    - Accurate - \$3,217.50
  - Front Entrance
  - Does TOW have any interest in moving entryway or should we proceed with current plans?
3. Doggy Dooleys at all parks
- Will be installed next week
4. Fernwood and Lake Bessie Parks –
- On hold until stormwater repairs are complete – probably early 2022

d. P&R Website – Dena

3. **NEW BUSINESS**

- a. Robert would like the committee to create an official position on allowing businesses to monetize the parks.

b. **MINUTES**

- i. Approval - April Meeting and Workshop Meeting Minutes (Attached-Committee Option)

c. **Liaison Reports**

- i. Mandy David
- ii. Tonya Elliott-Moore

4. **NEXT MEETING DATE – Thursday June 3, 2021**

5. **ADJOURN**





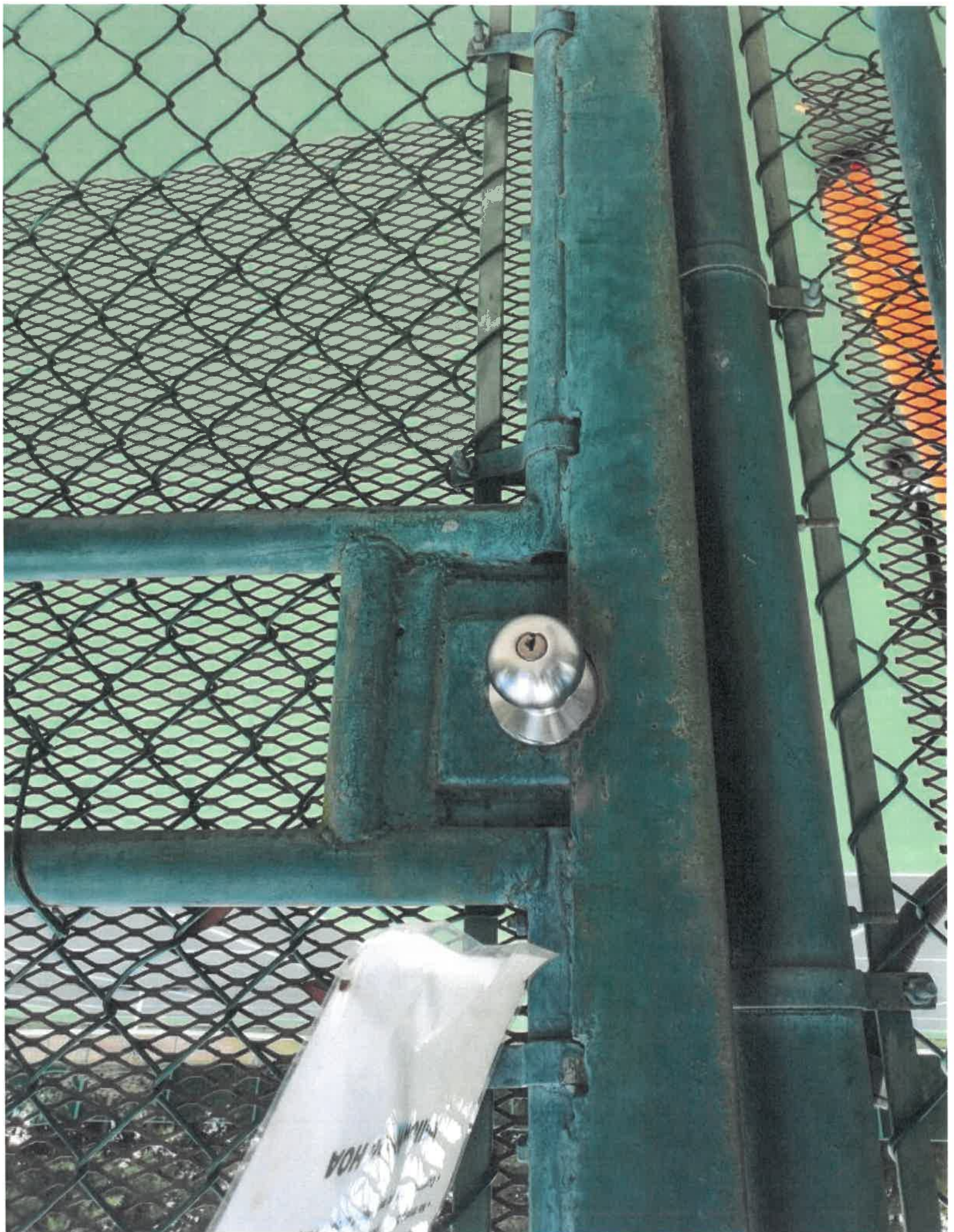

# Proposal

Page No.

1 of 2

Pages

## Varsity Courts, Inc.

1970-A CORPORATE SQUARE  
LONGWOOD, FLORIDA 32750  
407-830-8906 • FAX 407-830-7267

|   |               |  |                       |
|---|---------------|--|-----------------------|
| PROPOSAL SUBMITTED TO<br>Town of Windermere           |               | PHONE<br>(407) 595-0796                                    | DATE<br>April 6, 2021 |
| STREET<br>614 Main Street                             |               | JOB NAME<br>Resurface A Battery of Three (3) Tennis Courts |                       |
| CITY, STATE AND ZIP CODE<br>Windermere, Florida 34786 |               | JOB LOCATION<br>Main Street Park - 520 Main Street         |                       |
| ARCHITECT<br>Attn: Tracy Mitchell                     | DATE OF PLANS | JOB PHONE  |                       |

We hereby submit the following specifications and estimates for:

### RESURFACE A BATTERY OF THREE (3) TENNIS COURTS - 160' x 120'

Varsity Courts, Inc. proposes to resurface a battery of three (3) tennis courts according to the following specifications. All surfacing materials shall be Latex-ite, manufactured by Dalton Enterprises, Inc. Application of all material shall be done in a workmanlike manner in accordance with the manufacturer's standard specifications.

Pressure wash where necessary

Repair cracks 1/16" or larger using crack filler. The crack filler is worked into the crack with a putty knife by hand.

Repair wide cracks using patch mix. The patch mix is worked into the crack with a putty knife by hand.

Repair large pit holes and gauges using crack filler

Repair several washouts at fence line using patch mix to help lesson standing water

Repair around net post foundation

Net posts to be painted

Reinstall Tennis Court Nets

Quick grind entire slab to remove cracked edges and any loose material

#### NOTE: THREE (3) COAT SYSTEM

The entire surface shall receive one (1) coat of Latex-ite Acrylic Surfacer to give texture and safer play

The entire surface shall receive two (2) coats of Latex-ite Acrylic Fortified Color System with sand.

The outside perimeter of asphalt outside of fence will receive one (1) coat of Latex-ite Acrylic Fortified Color System with sand.

Color of court to be **TWO TONE GREEN**

Playing lines to be striped two inches (2") wide, accurately located using **WHITE** Latex-ite.

**WE PROPOSE** hereby to furnish material and labor - complete in accordance with above specifications, for the sum of:

dollars (\$ \_\_\_\_\_ )

Payments to be made as specified below:

All material is guaranteed to be as specified. All work to be completed in a workmanlike manner according to standard practices. Any alteration or deviation from above specifications involving extra costs will be executed only upon written orders, and will become an extra charge over and above the estimate. All agreements contingent upon strikes, accidents or delays beyond our control. Owner to carry fire, tornado and other necessary insurance. Our workers are fully covered by Workmen's Compensation Insurance.

Authorized  
Signature \_\_\_\_\_

Note: This proposal may be  
withdrawn by us if not accepted within \_\_\_\_\_ days.

**ACCEPTANCE OF PROPOSAL:** The above prices, specifications and conditions are satisfactory and are hereby accepted. You are authorized to do the work as specified. Payment will be made as outlined above.

Signature \_\_\_\_\_

Date of Acceptance:

Signature \_\_\_\_\_

# Proposal

## Varsity Courts, Inc.

1970-A CORPORATE SQUARE  
LONGWOOD, FLORIDA 32750  
407-830-8906 • FAX 407-830-7267

|   |               |  |                       |
|---|---------------|--|-----------------------|
| PROPOSAL SUBMITTED TO<br>Town of Windermere           |               | PHONE<br>(407) 595-0796                                    | DATE<br>April 6, 2021 |
| STREET<br>614 Main Street                             |               | JOB NAME<br>Resurface A Battery of Three (3) Tennis Courts |                       |
| CITY, STATE AND ZIP CODE<br>Windermere, Florida 34786 |               | JOB LOCATION<br>Main Street Park - 520 Main Street         |                       |
| ARCHITECT<br>Attn: Tracy Mitchell                     | DATE OF PLANS |  | JOB PHONE             |

We hereby submit the following specifications and estimates for:

**PLEASE CIRCLE ALTERNATE IF YOU WISH TO ELECT**

**ALT. I: Supply and install three (3) new tennis nets with center straps. @ \$168.00 each. ADD: \$504.00**

**ALL MATERIALS AND WORKMANSHIP HAVE A FULL ONE YEAR WARRANTY**

**OWNER TO PROVIDE WATER SOURCE - HOSE BIB**

**\*NO WARRANTY ON CRACKS: NEW OR REOCCURING**

**PER THE US TENNIS COURT AND TRACK BUILDERS ASSOCIATION:  
PLEASE NOTE "WHENEVER REPAIR, RESURFACING OR OVERLAY IS CHOSEN, IT IS  
IMPORTANT FOR AN OWNER TO REALIZE THAT CRACKS ALWAYS RE-APPEAR".**

**Reason being is that the constant expansion and contraction of more than 7000 sq ft of surface, which is the area of a single tennis court, has a constant fluctuations in ambient temperatures.**

**These fluctuations can be greater in the winter. The asphalt has lost all flexibility because of aging and the loss of the oils which were in it when manufactured. This causes the asphalt to be rigid.**

**WE PROPOSE** hereby to furnish material and labor - complete in accordance with above specifications, for the sum of:

**Ten Thousand Eight Hundred Thirty Seven**

**\$10,837.00**

dollars (\$ \_\_\_\_\_ )

Payments to be made as specified below:  
**Upon completion of work**

All material is guaranteed to be as specified. All work to be completed in a workmanlike manner according to standard practices. Any alteration or deviation from above specifications involving extra costs will be executed only upon written orders, and will become an extra charge over and above the estimate. All agreements contingent upon strikes, accidents or delays beyond our control. Owner to carry fire, tornado and other necessary insurance. Our workers are fully covered by Workmen's Compensation Insurance.

Authorized Signature

*Dennis Brubeck (sm)*

Note: This proposal may be withdrawn by us if not accepted within **30** days.

**ACCEPTANCE OF PROPOSAL:** The above prices, specifications and conditions are satisfactory and are hereby accepted. You are authorized to do the work as specified. Payment will be made as outlined above.

Signature \_\_\_\_\_

Date of Acceptance: \_\_\_\_\_

Signature \_\_\_\_\_



## TENNIS PROPOSAL

Submitted To:

May 7, 2021

Town of Windermere

RE: Windermere Recreation Center Tennis Courts

11465 Park Avenue

Windermere, FL 34786

---

*Payment to be upon completion. Price subject to change after 45 days. Our Base Price to furnish materials and labor as outlined:*

**Three Courts: \$15,994.00**

---

### SCOPE OF WORK:

- 1) Machine sand surface of court.
- 2) Patch large open cracks 1/16" or larger with acrylic patch mix.
- 3) Flood courts and patch any areas holding water per ASBA and USTA guidelines.
- 4) Apply one (1) coat of Acrylic Resurfacer over the entire surface of the court.
- 5) Apply two (2) coats of Color Coating over the entire surface of the court.
  - a. Inbounds Color: Florida Green
  - b. Outbounds Color: Light Green
- 6) Paint regulation tennis court markings with white textured line paint.
- 7) Paint two (2) 60' markings with light green line paint on courts #1 & #2.
- 8) Remove loose material and paint existing net posts green.
- 9) Furnish and install three (1) new tennis nets.

### NOTES:

- 1) It is recommended owner should spray insects and vegetation on or around courts two weeks prior to work commencement.
- 2) Water must be allowed to drain from court surface. Do not block water flow on side of court with grass or landscaping.
- 3) Owner to provide suitable access for equipment, water, and electric as required.
- 4) Should owner request additional material applied or other work performed to the surface of court which is not outlined above, it will be at an extra cost.

### CRACKS IN TENNIS COURTS:

It should be noted that as your tennis court ages, it will develop cracks. After resurfacing, new cracks may appear and repaired cracks will reappear. Cracks develop in tennis courts for various reasons with the most common being:

- 1) Constant expansion and contraction of more than 7,000 square feet of surface per court in response to constant fluctuations in ambient temperatures. These daily fluctuations are often greatest in winter.
- 2) Loss of flexibility of the asphalt as it ages and loses the oils used in the manufacturing process.
- 3) Changes in subsurface stability reflecting through the court surface.

Nidy does **NOT** provide any written or implied guarantee of tennis courts being free from existing or new cracks; thus, cannot and does not warrant against new cracks appearing or old cracks reappearing after the court has been resurfaced.



Estimator: Chris Tappan

**WARRANTY:**

Color Coating is warranted against any excessive fading for a period of one year from application. Surface is warranted against peeling and flaking for a period of one year from application. Problems from normal wear, vandalism, and improper care are excluded.

**Optional Adds:**

Furnish and Install one (1) new sets of green tennis posts – ***ADD \$350.00***

Apply ARMOR Crack Repair System to approximately 125' of serious cracks – ***ADD \$2,500.00***

Owner's Name & Billing Address: \_\_\_\_\_

Job Site's Contact Name & Phone: \_\_\_\_\_

Job Site's Address: \_\_\_\_\_

\_\_\_\_\_  
Authorized Signature

\_\_\_\_\_  
Total Dollar Amount Authorized

\_\_\_\_\_  
Date



7011 Wilson Rd.  
WPB Fl. 33413  
561-964-2001 Fax: 561-964-5009  
[www.sportsurfaces.com](http://www.sportsurfaces.com)

April 13, 2021

Attn: Tonya Elliott Moore

Town of Windermere

Windermere Tennis Association  
520 Main Street  
Windermere, FL

Dear Tonya,

Thank you for interest in Sport Surfaces for the resurfacing of your tennis courts.

Here at Sports Surfaces, we believe that the key to successful business is having the right product/service at the right time, offering the best quality for the lowest price. We back this up with a two-year warranty unlike most of our competitors who only offer a one-year warranty. We are continually striving to be the most innovative, creative, service minded company in the tennis industry.

We have over 100 years of combined experience and our highly skilled technicians are trained to perform all phases of athletic court construction, resurfacing and maintenance.

Sports Surfaces has installed top quality athletic courts right in your neighborhood and all over the world. Our Company has a long list of satisfied customers ranging from the US Coast Guard to top seated players.

In addition we carry a full line of sport court equipment, accessories and lighting products

Please let us know if you have any questions or comments. For more detailed information about our services and products, please visit our web page at [www.sportsurfaces.com](http://www.sportsurfaces.com)

We look forward to hearing from you and the possibility of doing business with you. Our reputation and work history guarantee you have made the right decision.

Sincerely,

*Sheila Dobbin*

Sales Estimator -Sport Surfaces llc.



7011 Wilson Rd.  
WPB FL. 33413  
561-964-2001 Fax: 561-964-5009  
[www.sportsurfaces.com](http://www.sportsurfaces.com)

## PROPOSAL/AGREEMENT

April 13, 2021

Town of Windermere

Windermere Tennis Association  
520 Main Street  
Windermere, FL

Agreement made between Sports Surfaces LLC. hereinafter called the Contractor and Town of Windermere, hereinafter called the Customer for the resurfacing (3) tennis courts with respect to the following terms and specifications:

**TENNIS COURT PREPARATION:** Area to be approximately: 156' X 120'

The Contractor will pressure clean and power blow court(s) as necessary to remove loose dirt, mildew and oil.  
The Contractor will patch depressions greater than 1/8" after 1 hour drying time in sunlight, grind down any ridges as necessary and fill existing cracks as best as possible prior to surfacing.  
Note: court must have a minimum of 1% slope in one plane in order to guarantee removal of water.  
The Contractor will apply fiberglass mesh strips on the cracks (Court I: 510' / Court II: 470' / Court III: 450').  
The Contractor will sand and paint existing net posts.

### **SURFACING OF TENNIS COURT(S)**

The Contractor will apply **(2) Coat of Acrylic Resurfacer** over entire court area to fill voids and provide smooth surface.  
The Contractor will apply **(2) Coats of Acrylic Color Concentrate** (two-tone), To provide in depth color over court surface.  
*Inner court color choice \_\_\_\_\_ Outer court color choice \_\_\_\_\_*  
(Colors may be selected by visiting <http://www.sportsurfaces.com/color-selector/>)  
The Contractor will accurately locate, mark, and paint two inch wide playing lines in accordance with U.S.T.A. regulations using white textured heavy bodied acrylic latex paint.  
The Contractor shall thoroughly and expediently clean up all drums, trash, etc. upon job completion.

### **PROVISIONS**

The Customer agrees to pay a 33% deposit upon acceptance of proposal.  
The Customer agrees to pay a 33% deposit upon commencement.  
The Customer agrees to pay balance upon completion of the above-proposed work.

### **Privacy / Terms and Conditions Policy:**

CUSTOMER AGREES THAT BY SIGNING THE BELOW CONTRACT THEY AGREE TO ABIDE BY OUR PRIVACY / TERMS AND CONDITIONS WHICH CAN BE FOUND BE FOUND ON OUR WEBSITE: <https://sportsurfaces.com/terms-and-conditions/>



7011 Wilson Rd.  
WPB Fl. 33413  
561-964-2001.Fax: 561-964-5009  
www.sportsurfaces.com

April 13, 2021

Town of Windermere

Windermere Tennis Association  
520 Main Street  
Windermere, FL

**CREDIT**

If the Customer does not pay as agreed upon, the Contractor shall have the right to file a lien against the real estate for the amount of the work done. No further work shall be accomplished if installment payments are not made at the time specified. In the event it is necessary to employ the services of an attorney to secure payment, as per the terms of this agreement, then the customer agrees to pay reasonable attorney fees. Interest of 1 ½ % per month will be charged on accounts past due.

**GUARANTEE**

The Contractor guarantees all work against defects in workmanship or materials for a **period of (2) years** from date of completion. This guarantee excludes Normal wear and tear, physical abuse or neglect and any other conditions beyond the contractor’s control, such as sub-base settling, cracks, hydrostatic pressure or water vapor pressure bubbles, intrusion of weeds or grass, etc. Proper tennis shoes must be worn on court. Some sneakers, street shoes, dark soled shoes, skateboards, roller blades, etc. will scuff and damage surface. Guarantee shall become void upon owner’s failure to adhere and comply with the payment schedule.

**FEE FOR THE TENNIS COURTS:**

The Contractor agrees to provide tools, materials, labor, supervision and insurance to complete the above work for a sum of **\*\*\*NINETEEN THOUSAND AND TWO HUNDRED DOLLARS (\$19,200.00) \*\*\*\***

\*All prices are in US Dollars. Prices are subject to change after thirty days. Our bid prices are based upon you providing adequate access and storage areas.

Respectfully submitted by: ***Sheila Dobbin***  
Sheila Dobbin  
Sales Estimator - Sport Surfaces llc.

Proposal accepted by: \_\_\_\_\_ Title: \_\_\_\_\_ Date: \_\_\_\_\_



Southwest FL Numbers  
 Naples: 239-597-9500  
 Ft. Myers: 239-772-4234

Orlando Area: 407-412-6156  
 Southeast FL: 954-903-4650  
 Tampa Bay: 813-949-2288

TO: Windermere Public Works  
 630 Main Street  
 Windermere FL 34786  
 407-876-2563 x5325

Attn: Travis Mathias  
 tmathias@town.windermere.fl.us

**QUOTATION # 04261**

|                     |                       |
|---------------------|-----------------------|
| <b>Date:</b>        | April 26, 2021        |
| <b>Ship Date:</b>   | Approx 4-5 Weeks ARO  |
| <b>Terms:</b>       | Net 30 Days           |
| <b>F.O.B.:</b>      | Destination           |
| <b>Salesperson:</b> | Tim Hill 407-412-6156 |
| <b>Shipped Via:</b> | CC                    |

| Quantity                        | Description   | Unit Price   | Total                         |
|---------------------------------|---|--------------|-------------------------------|
| <b>Henderson</b>                |   |              |                               |
| 1                               | #B307418R0 Modular Play Structure 3.5" O.D. Posts (see drawings)<br>Less 6% Discount (per Manatee Co. S.B. Bid #21-0053-MR) | \$ 17,593.00 | \$ 17,593.00<br>\$ (1,055.58) |
|                                 | Shipping & Handling   |              | \$ 16,537.42<br>\$ 1,080.00   |
|                                 | Additional Preferred Customer Discount  |              | \$ 17,617.42<br>\$ (317.42)   |
|                                 | Total Delivered Henderson   |              | \$ 17,300.00                  |
| <b>Superior Play Components</b> |   |              |                               |
| 2                               | #S-02 Commercial Belt Seat w/ Steel Core (Black)  | \$ 32.00     | \$ 64.00                      |
| 4                               | #SH-24 Galvanized 3-1/2" O.D. Swing Hanger w/ Clevis  | \$ 31.00     | \$ 124.00                     |
| 4                               | #SH-40 Single Clevis Connector  | \$ 4.75      | \$ 19.00                      |
| 2                               | #SH-41 Clevis Key (wrench)  | \$ 3.00      | \$ 6.00                       |
| 24 ft.                          | #H-40 Galvanized 4/0 Playground Swing Chain   | \$ 3.00      | \$ 72.00                      |
| 1                               | #BSIS-25T Inclusive Swing for 2-5 yrs. (Green w/ Tan Brace)   | \$ 659.00    | \$ 659.00                     |
| 1                               | #BSIS-512T Inclusive Swing for 5-12 yrs. (Green w/ Tan Brace)   | \$ 659.00    | \$ 659.00                     |
|                                 | 5.5% Material Surcharge (effective 3/15/21)   |              | \$ 1,603.00<br>\$ 88.17       |
|                                 | Less 10% Discount (per Charlotte Co. S.B. Bid #20/21-619GB)   |              | \$ 1,691.17<br>\$ (169.12)    |
|                                 | Shipping & Handling   |              | \$ 1,522.05<br>\$ 232.00      |
|                                 | Total Delivered Superior  |              | \$ 1,754.05                   |
| continued...                    |   |              |                               |



|  |   |
|--|---|
| E-mail: <a href="mailto:mail@parkplayusa.com">mail@parkplayusa.com</a><br><a href="http://www.parkplayusa.com">www.parkplayusa.com</a> |   |
| Southwest FL Numbers<br>Naples: 239-597-9500<br>Ft. Myers: 239-772-4234  | Orlando Area: 407-412-6156<br>Southeast FL: 954-903-4650<br>Tampa Bay: 813-949-2288 |

Page 2 of 2

TO: Windermere Public Works  
630 Main Street  
Windermere FL 34786  
407-876-2563 x5325

Attn: Travis Mathias  
tmathias@town.windermere.fl.us

**QUOTATION # 04261**

|                     |                       |
|---------------------|-----------------------|
| <b>Date:</b>        | April 26, 2021        |
| <b>Ship Date:</b>   | Approx 4-5 Weeks ARO  |
| <b>Terms:</b>       | Net 30 Days           |
| <b>F.O.B.:</b>      | Destination           |
| <b>Salesperson:</b> | Tim Hill 407-412-6156 |
| <b>Shipped Via:</b> | CC                    |

| Quantity | Description   | Unit Price | Total               |
|----------|---|------------|---------------------|
|          | <b>Action Play Systems</b>  |            |                     |
| 48       | #BORDER12 12" High x 4' Playground Border (black) w/ 30" Spike  | \$ 35.00   | \$ 1,680.00         |
| 1        | #ADAHalfRamp Half Ramp System for 12" Border  | \$ 500.00  | \$ 500.00           |
|          |   |            | \$ 2,180.00         |
|          | Less 10% Discount (per Charlotte Co. S.B. Bid #20/21-619GB)   |            | \$ (218.00)         |
|          |   |            | \$ 1,962.00         |
|          | Shipping & Handling   |            | \$ 466.00           |
|          | Total Delivered APS   |            | \$ 2,428.00         |
|          | Total Delivered Materials   |            | \$ 21,799.47        |
|          | Installation (Includes Relocation of Swing Frame)   |            | \$ 6,600.00         |
|          | <b>TOTAL PRICE</b>  |            | <b>\$ 28,399.47</b> |
|          | Price does not include any permits or associated fees, if applicable<br>Price does not include any wood chip surfacing material (By Owner)<br>Price based on standard colors<br>Price valid for 30 days.<br><br>Optional Installation by Kennico, Inc or others<br><br>Thank you. |            |                     |

**Presented to: The Town of Windermere Parks & Rec Board**  
**Windermere Recreation Center – Lake Butler**



**Presented by: Audra Bussey, CPSI**  
**Kompan Playgrounds**

**May 7, 2021**



**Option #1: Yellowstone 2-12 structure: Estimated Price; \$64,125**

*Includes: Equipment, installation, freight, permits, engineered stamped drawings, EWR surfacing, ADA ramp, and borders.*

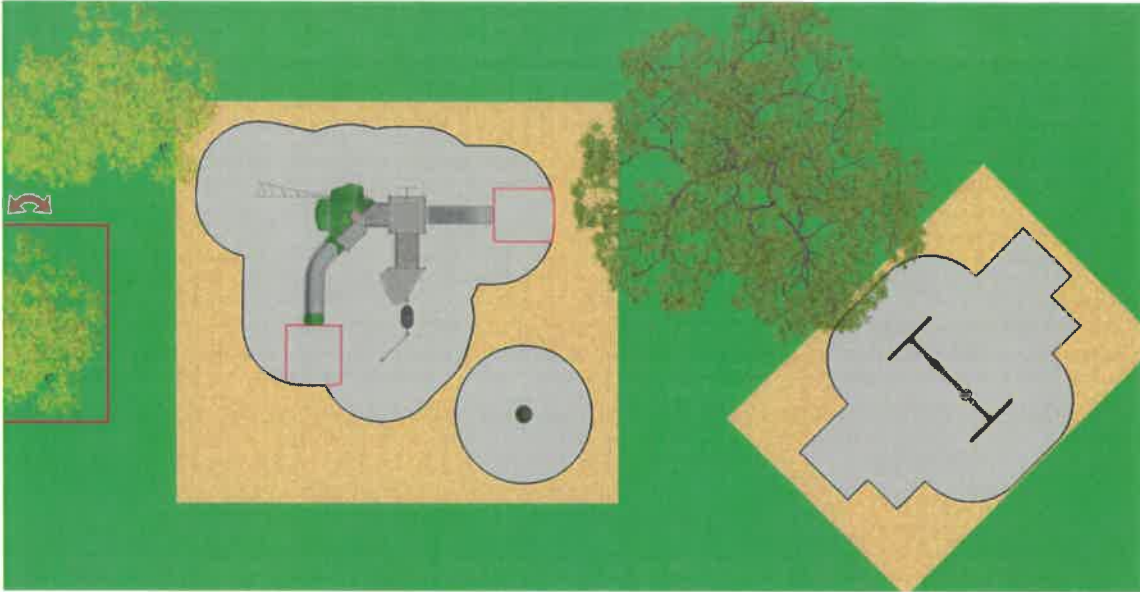







# Yellowstone with Roof

PCE211102



|                                    |                    |
|------------------------------------|--------------------|
| Item no. PCE211102-0902            |                    |
| <b>General Product Information</b> |                    |
| Dimensions LxWxH                   | 23'7"x17'10"x16'2" |
| Age group                          | 2 - 12             |
| Play capacity (users)              | 19                 |
| Color options                      |                    |

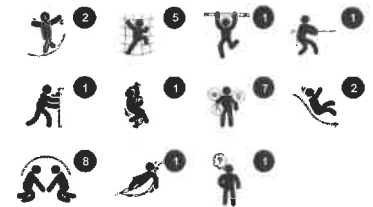

Wow! This exciting play structure is rich in options for children's play, as they climb and descend Yellowstone. The variation will encourage children to come back for play again and again. Graduated challenges and thrills are built in. The accessible stairway offers a loop of play for all with a lower and higher slide and a gently swaying hammock. Sliding develops the

child's sense of balance and its trunk stability, skills important for the ability to sit still. Slides additionally train children's turn-taking and empathy, both important social-emotional skills that are hard to teach but easy to gain in play. core strength and posture. All accesses are graded in challenge. The Jacob's ladder takes great consideration to manage. It supports the

development of proprioception and spatial awareness, both fundamental in negotiating space securely.



Data is subject to change without prior notice.

# Yellowstone with Roof

PCE211102



Panels of 19mm EcoCore™. EcoCore™ is a highly durable, eco friendly material, which is not only recyclable after use, but also consists of a core produced from 100% recycled material.



The ELEMENTS roofs are made of recyclable PE with a minimum wall thickness of 5 mm to ensure high durability in all climates around the world. The steel pipes are hot dip galvanized inside and outside for maximum durability.



Sails of commercial 95 high density PE knitted specially for sun-shade structures. The sails are treated with UV stabilizers to ensure a long lifetime. The sails are supported by a hot dip galvanized steel frame and tightened by stainless steel devices.

|                                 |             |
|---------------------------------|-------------|
| Item no. PCE211102-0902         |             |
| <b>Installation Information</b> |             |
| Max. fall height                | 7'3"        |
| Safety surfacing area           | 744 ft2     |
| Number of installers            | 2           |
| Total installation time         | 30.7        |
| Excavation volume               | 0.86 yd3    |
| Concrete volume                 | 0.05 yd3    |
| Footing depth (standard)        | 2'9"        |
| Shipment weight                 | 1,867 lbs   |
| Anchoring options               | In-ground ✓ |
| <b>Warranty Information</b>     |             |
| EcoCore HDPE                    | Lifetime    |
| Post                            | 10 years    |
| HPL decks                       | 15 years    |
| Sun shading sails               | 2 years     |
| Spare parts guaranteed          | 10 years    |



ELEMENTS decks are made of 17.8mm thick HPL supported by a unique designed aluminum frame with multiple attachment options by usage of aluminum connectors. The main posts are made of high quality pre-galvanized steel with powder coated top finish. Post tops are closed with caps of UV stabilised nylon (PA6).



The slides are available in either molded PE in different colors or in full stainless steel AISI304 t= 2mm.



Steel activities are hot dip galvanized and optional with a powder coated top finish.

| Elevated activities 6 | Accessible elevated activities | Accessible ground level activities | Accessible ground level play types |
|-----------------------|--------------------------------|------------------------------------|------------------------------------|
| Present               | 6                              | 2                                  | 2                                  |
| Required              | 3                              | 2                                  | 2                                  |

2 / 3/5/2021

Data is subject to change without prior notice.

# Yellowstone with Roof

PCE211102



\* Max fall height | \*\* Total height | \*\*\* Safety surfacing area

\* Max fall height | \*\* Total height

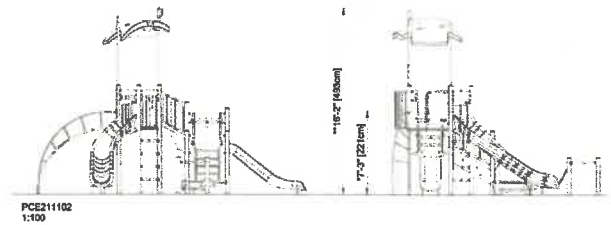
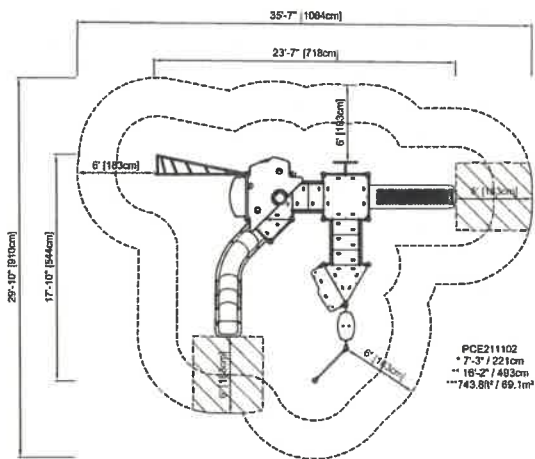

[Click to see 1:100 ratio TOP VIEW](#)

[Click to see 1:100 ratio SIDE VIEW](#)

# Yellowstone with Roof

PCE211102



## Balcony

**Social-Emotional:** the balcony invites meetings and interaction with people on ground level.  
**Cognitive:** invites dramatic play and performance, which stimulates language development.



## Climbing pole

**Physical:** cross-coordination and muscle strength are trained.  
**Social-Emotional:** turn-taking and cooperation.



## Stairway

**Physical:** climbing the transfer step is for all and supports cross-coordination as well as arm and leg muscles.  
**Social-Emotional:** room for active breaks and adult helpers. An inclusive space.



## Jacob's ladder

**Physical:** cross-coordination and spatial awareness as well as upper body muscles when hanging with arms. This is especially important due to sedentary lifestyles of today's children.  
**Social-Emotional:** turn-taking and cooperation.  
**Cognitive:** logical thinking when going from 2nd to 3rd step, changing feet.



## Curved slide

**Physical:** sliding develops spatial awareness and a sense of balance. Furthermore, the core muscles are trained when sitting upright going down.  
**Social-Emotional:** empathy stimulated by turn-taking.



## Pipe ladder

**Physical:** cross-coordination and eye-hand coordination are supported when children climb the ladder. The climbing also supports leg and arm muscles.  
**Social-Emotional:** social interaction when hanging out together, learning about turn taking and cooperation.



## Somersault bar

**Physical:** arm, leg and core muscles are developed when climbing up, somersaulting around. Balance and spatial awareness are strengthened.  
**Social-Emotional:** room for many, socializing.



## Hammock

**Physical:** coordination and sense of balance when swaying.  
**Social-Emotional:** pushing friends gently back and forth, turn-taking.  
**Cognitive:** for toddlers cause and effect understanding.



# Yellowstone with Roof

PCE211102



**PHYSICAL**  
Joy of movement:  
motor skills, muscle, cardio  
and bone density



**SOCIAL-EMOTIONAL**  
Joy of being together:  
teamwork, tolerance and  
sense of belonging



**COGNITIVE**  
Joy of learning:  
curiosity, understanding of causal  
relationships and knowledge of the world



**CREATIVE**  
Joy of creating:  
co-creation and experimenting  
with materials



**BALANCE**  
To balance is to stay upright when walking or standing on a surface that makes this challenging (e.g. a wobbly, inclined, or narrow surface).



**HANG IN ARMS**  
To hang in arms is the act of carrying the body with the hands or arms, possibly to traverse to another platform or play item.



**SENSORY**  
To sense is the act of taking in information with the sensory system: seeing, feeling, hearing or sensing with the body.



**BOUNCE**  
To bounce is the act of bouncing on a responsive, flexible, elastic or tensile surface.



**JUMP**  
To jump is the act of jumping up or down on a hard surface.



**SLIDE**  
To slide is the act of moving fast downwards seated on a slide.



**CLIMB**  
To climb is the act of moving upwards, cross-coordinating arms and legs, on a vertical or inclined surface or net.



**PULL**  
To pull is the act of pulling an item towards you or you towards an item with one or both hands, or possibly using the entire body.



**SOCIALIZE**  
To socialize is the act of meeting, communicating or cooperating in an activity that stimulates and facilitates social interaction.



**CONSTRUCT**  
To construct is the act of creating new patterns, shifting items or materials to new positions or constructing with materials that can be transformed or manipulated.



**PUSH**  
To push is the act of pushing an item away from you with one or both hands, possibly with the entire body.



**SPIN**  
To spin involves a fast, repeated horizontal or vertical turn of the body on a piece of equipment that facilitates the movement.



**CRAWL**  
To crawl is the movement of moving forwards or backwards, cross-coordinating arms and legs, on a horizontal or slightly inclined surface.



**ROCK**  
To rock is the action of rocking back and forth, or sideways, on e.g. a piece of spring equipment.



**SWAY**  
To sway is the movement of swaying back and forth, or around, lying, seated or possibly standing, in a pendulant or circular movement, e.g. on a hammock or on a rope.



**DRAMATIC PLAY**  
Dramatic play is motivated through play items that stage a frame, place or environment for acting out make believe or role play scenarios.



**ROTATE**  
To rotate involves a vertical or horizontal slower paced turn of the body, facilitated by a piece of equipment.



**SWING**  
To swing is the movement of swinging back and forth, or in circular movement, seated, standing or lying, in an unhindered arc.



**GLIDE**  
To glide is the act of moving from one point to another without shifting the feet, in a horizontal or vertical movement, in a seated, lying or standing position, letting gravity do the work.



**RULES PLAY**  
Rules play is motivated through play items that suggest games-with-rules, cooperation and team work, e.g. tic-tac-toe, timers or ball games.



**WONDER**  
To wonder is motivated through play items that make children need and use their logical, abstract or creative thinking skills, as well as their memory.

# SPINNER BOWL

ELE400024



|                             |                   |
|-----------------------------|-------------------|
| Item no. ELE400024-3717LG   |                   |
| General Product Information |                   |
| Dimensions LxWxH            | 1'11" x 1'8" x 2" |
| Age Group                   | 5+                |
| Play Capacity               | 1 child           |
| Color Options               |                   |



This wildly or mildly spinning piece with its cute rounded design evokes squeals of joy when children rotate again and again. With its easily accessible, tilted spinning bowl it invites children of all abilities and a wide age span to play. The small footprint allows for placing 2-3 Spinner Bowls together, encouraging social play. The variety of play opportunities include

sitting in, on edge of, pushing, pulling or even standing in the spinner bowl. These make the Spinner Bowl a long-time attraction. The tilted bowl allows the child to adjust the spinning speed with their body movements. This trains the logical thinking to speed up by scooping up or slow down by spreading arms and legs out. Spinner Bowls train the sense of balance,

which is mandatory for concentration skills and the ability to sit still. Pushing or being pushed by others trains social-emotional skills such as turn-taking.





# SPINNER BOWL

ELE400024



The Spinner Bowl is made of 100% recyclable PE plastic. The bowl is molded in one piece with integrated metal thread bushings and water drain hole to ensure high durability in all climates around the world.

Heavy duty engineered bearing system with single row deep groove ball bearings with rubber seals. The fully closed bearing construction is lifetime lubricated and maintenance free.

The steel surface is hot dip galvanized inside and outside with lead free zinc according to global safety standards for playground equipment.

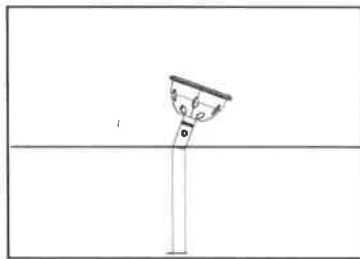

Hardware connections are covered by unique two piece designed PA6 donuts. The base donut is curved to adapt the shape of the steel pipe and the do-nut cap covers and protect the bolt head.

In-ground anchoring with base plate available in different depths depending on the individual playground. The Spinner Bowl is also available for surface installation with expansion bolts.

The Spinner Bowl is available in five different color options.

|                                 |  |
|---------------------------------|--|
| Item no. ELE400024-3717LG       |  |
| <b>Installation Information</b> |  |
| Max. fall height                | 1'6"   |
| Safety surfacing area           | 148,3ft <sup>2</sup>   |
| Numbers of Installers (persons) | 2  |
| Total installation time         | 2  |
| Excavation volume               | 0,15 yd <sup>3</sup>   |
| Concrete volume                 | 0,08 yd <sup>3</sup>   |
| Footing Depth (Standard)        | 2'11"  |
| Shipment Weight                 | 48   |
| Anchoring options               | In-ground <input checked="" type="checkbox"/><br>Surface <input checked="" type="checkbox"/> |
| <b>Warranty information</b>     |  |
| PE Plastic Bowl                 | 10 Years   |
| Bearing system                  | 5 Years  |
| Galvanized steel                | 10 Years   |
| Hardware                        | 10 Years   |
| Spare parts guaranteed          | 10 Years   |

| Elevated Activities 0 | Accessible Elevated Activities | Accessible Ground Level Activities | Accessible Ground Level Play Types |
|-----------------------|--------------------------------|------------------------------------|------------------------------------|
| Present               | 0                              | 1                                  | 1                                  |
| Required              | 0                              | 1                                  | 1                                  |



To verify product certification, visit [www.ipema.org](http://www.ipema.org)

# SPINNER BOWL

ELE400024



\*Max fall height | \*\*Total height | \*\*\*Safety surfacing area

\*Max fall height | \*\*Total height

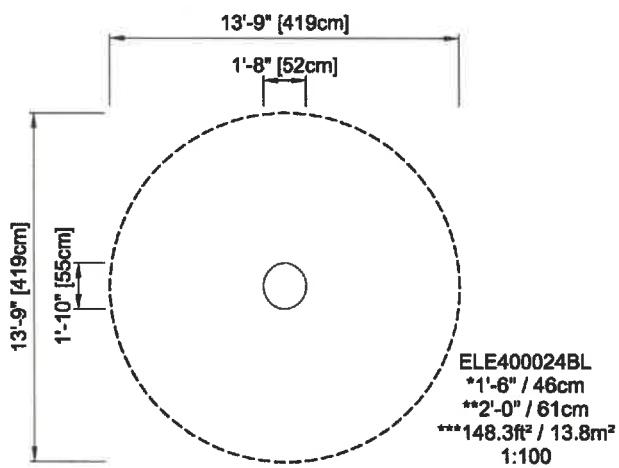

ELE400024BL  
ELE400024GR  
ELE400024RE  
ELE400024E  
ELE400024F  
1:100

[Click to see 1:100 ratio TOP VIEW](#)

[Click to see 1:100 ratio SIDE VIEW](#)

# SPINNER BOWL

ELE400024



## Tilted, spinning bowl

**Physical:** the sense of balance and the coordination are trained when spinning. This effects positively for instance the ability to sit still for longer periods. The muscles are trained when pushing or pulling friends.

**Social-Emotional:** feeling of security when scooping up in the bowl. Inclusive: for all abilities.

**Cognitive:** logical thinking when speeding up or down the spin by either curling up or stretching.



## Deep bowl

**Physical:** use of cross-coordination when entering, balance when sitting on knees on edge

**Social-Emotional:** cooperation, helping others, turn-taking

# SPINNER BOWL

ELE400024



**PHYSICAL**  
Joy of movement:  
motor skills, muscle, cardio  
and bone density



**SOCIAL-EMOTIONAL**  
Joy of being together:  
teamwork, tolerance and  
sense of belonging



**COGNITIVE**  
Joy of learning:  
curiosity, understanding of causal  
relationships and knowledge of the world



**CREATIVE**  
Joy of creating:  
co-creation and experimenting  
with materials



**BALANCE**  
To balance is to stay upright when walking or standing on a surface that makes this challenging (e.g. a wobbly, inclined, or narrow surface).



**Overhead HANG**  
Overhead hang is the act of carrying the body with the hands or arms, possibly to traverse to another platform or play item.



**SENSORY**  
To sense is the act of taking in information with the sensory system: seeing, feeling, hearing or sensing with the body.



**BOUNCE**  
To bounce is the act of bouncing on a responsive, flexible, elastic or tensile surface.



**JUMP**  
To jump is the act of jumping up or down on a hard surface.



**SLIDE**  
To slide is the act of moving fast downwards seated on a slide.



**CLIMB**  
To climb is the act of moving upwards, cross-coordinating arms and legs, on a vertical or inclined surface or net.



**PULL**  
To pull is the act of pulling an item towards you or you towards an item with one or both hands, or possibly using the entire body.



**SOCIALIZE**  
To socialize is the act of meeting, communicating or cooperating in an activity that stimulates and facilitates social interaction.



**CONSTRUCT**  
To construct is the act of creating new patterns, shifting items or materials to new positions or constructing with materials that can be transformed or manipulated.



**PUSH**  
To push is the act of pushing an item away from you with one or both hands, possibly with the entire body.



**SPIN**  
To spin involves a fast, repeated horizontal or vertical turn of the body on a piece of equipment that facilitates the movement.



**CRAWL**  
To crawl is the movement of moving forwards or backwards, cross-coordinating arms and legs, on a horizontal or slightly inclined surface.



**ROCK**  
To rock is the action of rocking back and forth, or sideways, e.g. on a piece of spring equipment.



**SWAY**  
To sway is the movement of swaying back and forth, or around, lying, seated or possibly standing, in a pendulant or circular movement, e.g. on a hammock or on a rope.



**DRAMATIC PLAY**  
Dramatic play is motivated through play items that stage a frame, place or environment for acting out make believe or role play scenarios.



**ROTATE**  
To rotate involves a vertical or horizontal slower paced turn of the body, facilitated by a piece of equipment.



**SWING**  
To swing is the movement of swinging back and forth, or in circular movement, seated, standing or lying, in an unhindered arc.



**GLIDE**  
To glide is the act of moving from one point to another without shifting the feet, in a horizontal or vertical movement, in a seated, lying or standing position, letting gravity do the work.



**RULE PLAY**  
Rule play is motivated through play items that suggest games-with-rules, cooperation and teamwork, e.g. tic-tac-toe, timers or ball games.



**WONDER**  
To wonder is motivated through play items that make children need and use their logical, abstract or creative thinking skills, as well as their memory.

**Option #2: Grand Canyon Essentials 2-12 structure: \$70,983**

*Includes: Equipment, installation, freight, permits, engineered stamped drawings, EWR surfacing, ADA ramp, and borders.*

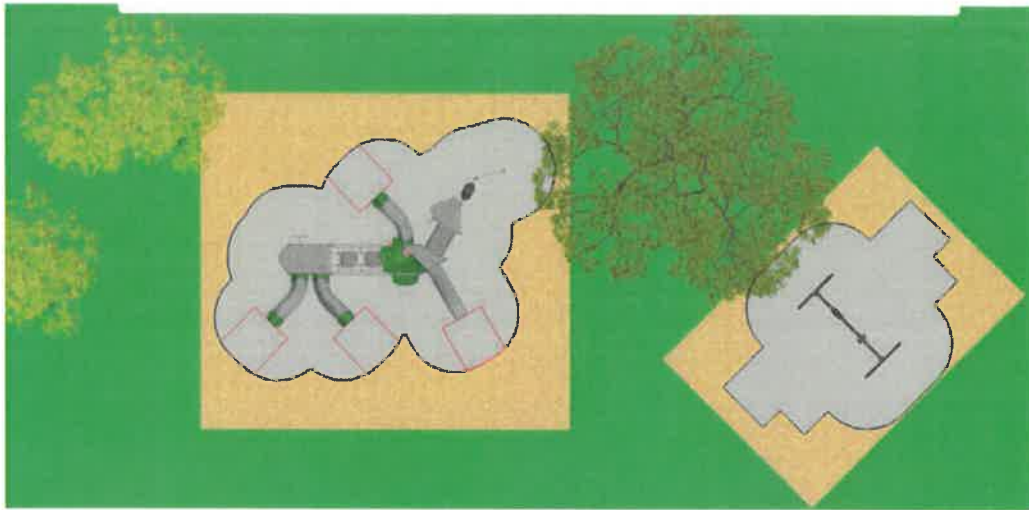



# Grand Canyon with Roof

PCE211202



|                                    |                    |
|------------------------------------|--------------------|
| Item no. PCE211202-0902            |                    |
| <b>General Product Information</b> |                    |
| Dimensions LxWxH                   | 28'7"x18'10"x14'2" |
| Age group                          | 2 - 12             |
| Play capacity (users)              | 22                 |
| Color options                      |                    |

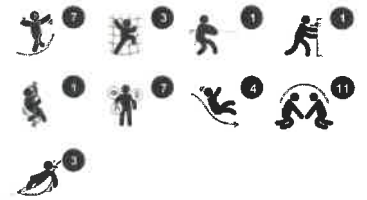

Wow! There are so many options for children's play in the Grand Canyon. Children are highly attracted to the structure, and will support longer playtimes for happy, healthy children and families. Graduated challenges and thrills are built in. The rich variation of accesses invites play for all. The rich sliding experiences apart from being great fun also develop balance

skills and trunk stability, important for the ability to sit still. The intentional design of the Grand Canyon supports social play, when turn-taking and cooperating around the slides. The Wackie Bridge is a wonderfully challenging feature, training the sense of balance as space, both important for negotiating space securely. Cooperation and consideration are put to full

use, developing the child's social-emotional skills. The hammock adds a rest point.



Data is subject to change without prior notice.

# Grand Canyon with Roof

PCE211202



Panels of 19mm EcoCore™. EcoCore™ is a highly durable, eco friendly material, which is not only recyclable after use, but also consists of a core produced from 100% recycled material.



The ELEMENTS roofs are made of recyclable PE with a minimum wall thickness of 5 mm to ensure high durability in all climates around the world. The steel pipes are hot dip galvanized inside and outside for maximum durability.



Sails of commercial 95 high density PE knitted specially for sun-shade structures. The sails are treated with UV stabilizers to ensure a long lifetime. The sails are supported by a hot dip galvanized steel frame and tightened by stainless steel devices.

|                                 |             |
|---------------------------------|-------------|
| Item no. PCE211202-0902         |             |
| <b>Installation Information</b> |             |
| Max. fall height                | 3'10"       |
| Safety surfacing area           | 894 ft2     |
| Numbers of installers (persons) | 2           |
| Total installation time         | 36.5        |
| Excavation volume               | 0.94 yd3    |
| Concrete volume                 | 0.05 yd3    |
| Footing depth (standard)        | 2'9"        |
| Shipment weight                 | 2,079 lbs   |
| Anchoring options               | In-ground ✓ |
| <b>Warranty Information</b>     |             |
| EcoCore HDPE                    | Lifetime    |
| Post                            | 10 years    |
| HPL decks                       | 10 years    |
| Sun shading sails               | 2 years     |
| Spare parts guaranteed          | 10 years    |



ELEMENTS decks are made of 17.8mm thick HPL supported by a unique designed aluminum frame with multiple attachment options by usage of aluminum connectors. The main posts are made of high quality pre-galvanized steel with powder coated top finish. Post tops are closed with caps of UV stabilised nylon (PA6).

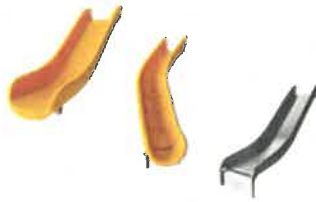

The slides are available in either molded PE in different colors or in full stainless steel AISI304 t= 2mm.



All steel activities has a unique surface treatment of hot dip galvanized base and powder coated top finish to provide durable products with long lifetime for all environments.

| Elevated activities 9 | Accessible elevated activities | Accessible ground level activities | Accessible ground level play types |
|-----------------------|--------------------------------|------------------------------------|------------------------------------|
| Present               | 9                              | 3                                  | 3                                  |
| Required              | 5                              | 3                                  | 3                                  |



# Grand Canyon with Roof

PCE211202



\* Max fall height | \*\* Total height | \*\*\* Safety surfacing area

\* Max fall height | \*\* Total height

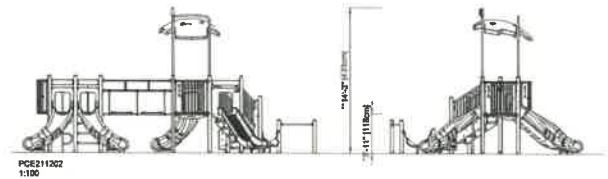
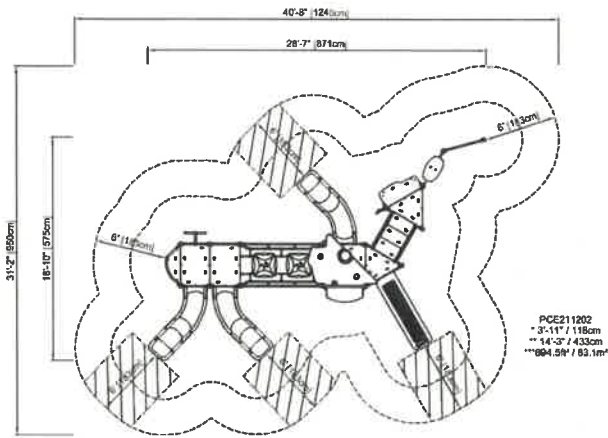

[Click to see 1:100 ratio TOP VIEW](#)

# Grand Canyon with Roof

PCE211202

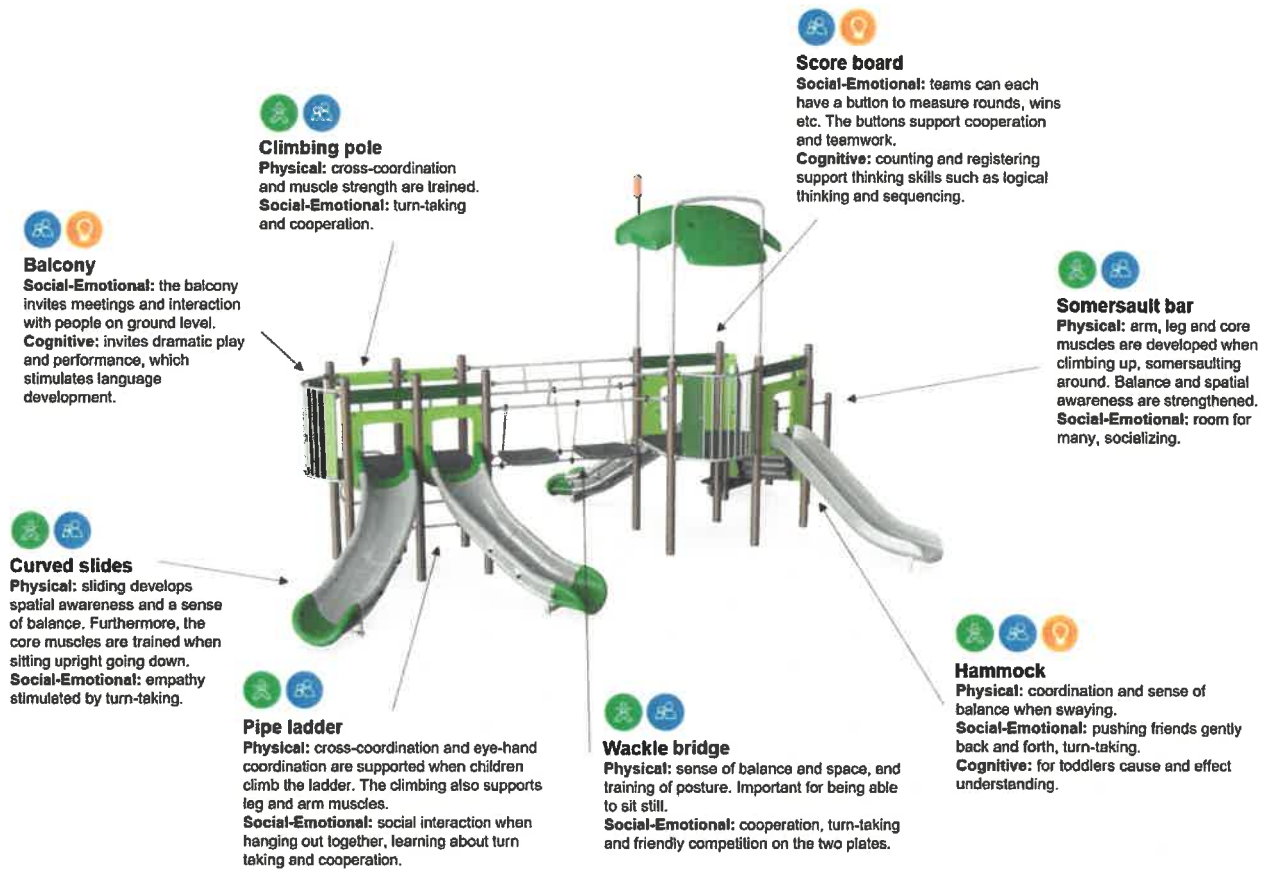

### Balcony

**Social-Emotional:** the balcony invites meetings and interaction with people on ground level.  
**Cognitive:** invites dramatic play and performance, which stimulates language development.



### Climbing pole

**Physical:** cross-coordination and muscle strength are trained.  
**Social-Emotional:** turn-taking and cooperation.



### Score board

**Social-Emotional:** teams can each have a button to measure rounds, wins etc. The buttons support cooperation and teamwork.  
**Cognitive:** counting and registering support thinking skills such as logical thinking and sequencing.



### Somersault bar

**Physical:** arm, leg and core muscles are developed when climbing up, somersaulting around. Balance and spatial awareness are strengthened.  
**Social-Emotional:** room for many, socializing.



### Curved slides

**Physical:** sliding develops spatial awareness and a sense of balance. Furthermore, the core muscles are trained when sitting upright going down.  
**Social-Emotional:** empathy stimulated by turn-taking.



### Pipe ladder

**Physical:** cross-coordination and eye-hand coordination are supported when children climb the ladder. The climbing also supports leg and arm muscles.  
**Social-Emotional:** social interaction when hanging out together, learning about turn taking and cooperation.



### Wackie bridge

**Physical:** sense of balance and space, and training of posture. Important for being able to sit still.  
**Social-Emotional:** cooperation, turn-taking and friendly competition on the two plates.



### Hammock

**Physical:** coordination and sense of balance when swaying.  
**Social-Emotional:** pushing friends gently back and forth, turn-taking.  
**Cognitive:** for toddlers cause and effect understanding.

# Grand Canyon with Roof



PCE211202



**PHYSICAL**  
Joy of movement:  
motor skills, muscle, cardio  
and bone density



**SOCIAL-EMOTIONAL**  
Joy of being together:  
teamwork, tolerance and  
sense of belonging



**COGNITIVE**  
Joy of learning:  
curiosity, understanding of causal  
relationships and knowledge of the world



**CREATIVE**  
Joy of creating:  
co-creation and experimenting  
with materials



**BALANCE**  
To balance is to stay upright when walking or standing on a surface that makes this challenging (e.g. a wobbly, inclined, or narrow surface).



**HANG IN ARMS**  
To hang in arms is the act of carrying the body with the hands or arms, possibly to traverse to another platform or play item.



**SENSORY**  
To sense is the act of taking in information with the sensory system: seeing, feeling, hearing or sensing with the body.



**BOUNCE**  
To bounce is the act of bouncing on a responsive, flexible, elastic or tensile surface.



**JUMP**  
To jump is the act of jumping up or down on a hard surface.



**SLIDE**  
To slide is the act of moving fast downwards seated on a slide.



**CLIMB**  
To climb is the act of moving upwards, cross-coordinating arms and legs, on a vertical or inclined surface or net.



**PULL**  
To pull is the act of pulling an item towards you or you towards an item with one or both hands, or possibly using the entire body.



**SOCIALIZE**  
To socialize is the act of meeting, communicating or cooperating in an activity that stimulates and facilitates social interaction.



**CONSTRUCT**  
To construct is the act of creating new patterns, shifting items or materials to new positions or constructing with materials that can be transformed or manipulated.



**PUSH**  
To push is the act of pushing an item away from you with one or both hands, possibly with the entire body.



**SPIN**  
To spin involves a fast, repeated horizontal or vertical turn of the body on a piece of equipment that facilitates the movement.



**CRAWL**  
To crawl is the movement of moving forwards or backwards, cross-coordinating arms and legs, on a horizontal or slightly inclined surface.



**ROCK**  
To rock is the action of rocking back and forth, or sideways, on e.g. a piece of spring equipment.



**SWAY**  
To sway is the movement of swaying back and forth, or around, lying, seated or possibly standing, in a pendulant or circular movement, e.g. on a hammock or on a rope.



**DRAMATIC PLAY**  
Dramatic play is motivated through play items that stage a frame, place or environment for acting out make believe or role play scenarios.



**ROTATE**  
To rotate involves a vertical or horizontal slower paced turn of the body, facilitated by a piece of equipment.



**SWING**  
To swing is the movement of swinging back and forth, or in circular movement, seated, standing or lying, in an unhindered arc.



**GLIDE**  
To glide is the act of moving from one point to another without shifting the feet, in a horizontal or vertical movement, in a seated, lying or standing position, letting gravity do the work.



**RULES PLAY**  
Rules play is motivated through play items that suggest games-with-rules, cooperation and team work, e.g. tic-tac-toe, timers or ball games.



**WONDER**  
To wonder is motivated through play items that make children need and use their logical, abstract or creative thinking skills, as well as their memory.

**Option #3 Robinia Tower 5-12 structure: Estimated Price: \$91,768**

*Includes: Equipment, installation, freight, permits, engineered stamped drawings, EWR surfacing, ADA ramp, and borders.*

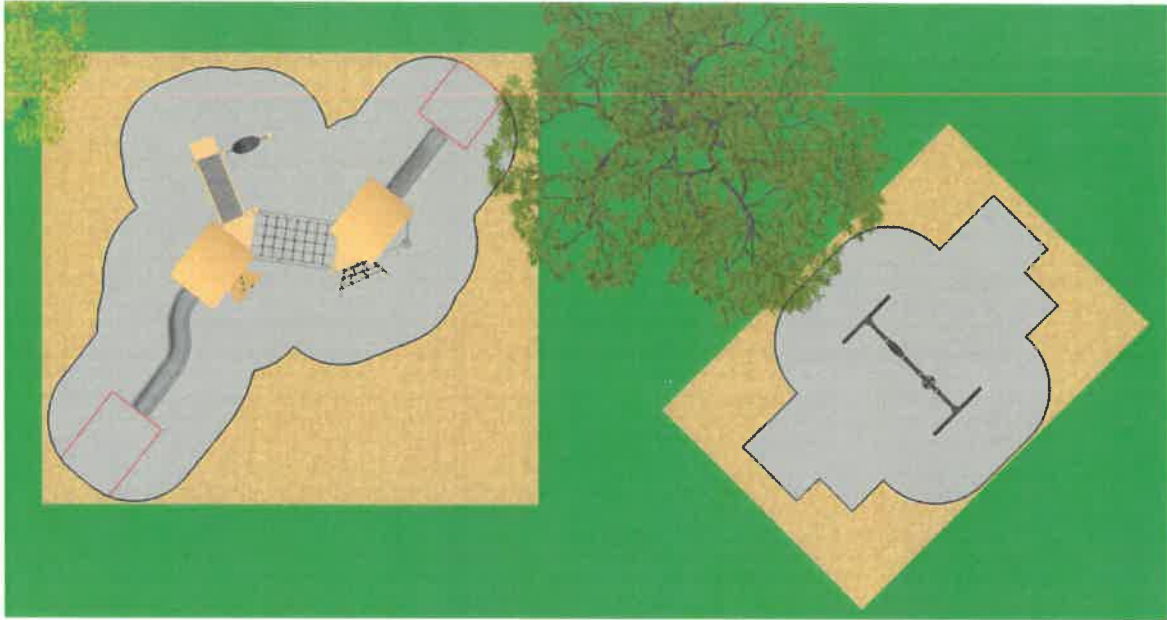



# THE WIZARD'S DOUBLE TOWER FORTRESS

NRO2010



Item no. NRO2010-1021

### General Product Information

|                       |                   |
|-----------------------|-------------------|
| Dimensions LxWxH      | 36'1"x21'2"x17'6" |
| Age group             | 5-12              |
| Play capacity (users) | 38                |
| Color options         |                   |

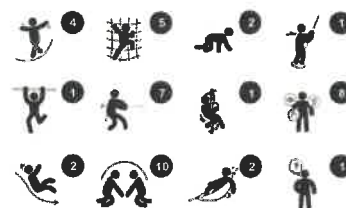

The voluminous Wizard's Double Tower Fortress is an irresistible play attraction for children. With its varied play corners and diverse physical play activities it attracts children again and again, for a long time. The stairway with hammock makes a nice haven for children of all abilities. The slides are thrilling rides down, training core stability as the child

sits upright when sliding. The variation of inclined wood and net accesses assist the child in climbing up in more or less challenging ways, training cross-coordination and leg, arm and core muscles. An inclined climb gives a greater sense of security than a vertical one, thus inviting a range of children of varied abilities. The curly climber is a rotating and downward

glide that stimulates balance as well as sense of space, both crucial in managing obstacles and traffic safely. The platforms on the ground and elevated areas invite meetings and exchanges.

# THE WIZARD'S DOUBLE TOWER FORTRESS

NRO2010



All Organic Robinia products by KOMPAN are made of 100% Robinia wood from sustainable European sources. On request it can be supplied with FSC® Certified (FSC® C004450) Robinia wood.



The paint used for colored components is water based environmental friendly with excellent UV resistance. The paint is in compliance with EN 71 Part 3.



The Robinia products are designed with a KOMPAN color concept with a number of different standard colors. The wood can also be supplied as untreated or with brown painted with a pigment that maintains the wood color.



The product/activities are preassembled from the factory to ensure all safety requirements are considered.



The hardware is made of stainless steel or galvanized steel to ensure durable connections with a high corrosion resistance.

|                                 |  |
|---------------------------------|--|
| Item no. NRO2010-1021           |  |
| <b>Installation Information</b> |  |
| Max. fall height                | 8'2"   |
| Safety surfacing area           | 968 ft <sup>2</sup>  |
| Numbers of installers (persons) | 2  |
| Total installation time         | 59.1   |
| Excavation volume               | 3.37 yd <sup>3</sup>   |
| Concrete volume                 | 0.47 yd <sup>3</sup>   |
| Footing depth (standard)        | 3'3"   |
| Shipment weight                 | 5,303 lbs  |
| Anchoring options               | In-ground <input checked="" type="checkbox"/><br>Surface <input checked="" type="checkbox"/> |
| <b>Warranty Information</b>     |  |
| Robinia Wood                    | 10 years   |
| Stainless steel components      | 10 years   |
| Hollow PE Parts                 | 10 years   |
| Ropes & nets                    | 5 years  |
| Spare parts guaranteed          | 10 years   |

| Elevated activities § | Accessible elevated activities | Accessible ground level activities | Accessible ground level play types |
|-----------------------|--------------------------------|------------------------------------|------------------------------------|
| Present               | 5                              | 2                                  | 2                                  |
| Required              | 4                              | 3                                  | 3                                  |

# THE WIZARD'S DOUBLE TOWER FORTRESS

NRO2010



\* Max fall height | \*\* Total height | \*\*\* Safety surfacing area

\* Max fall height | \*\* Total height

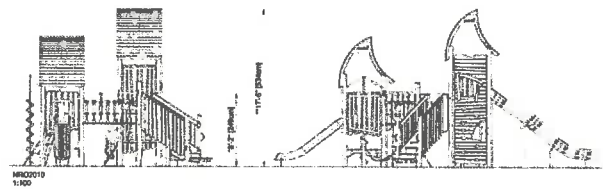
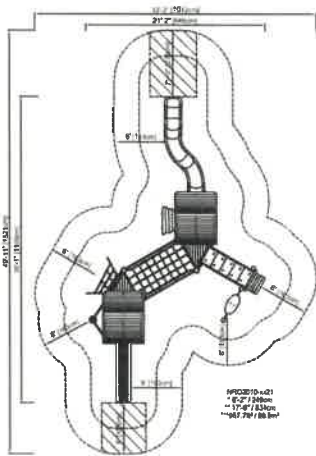

[Click to see 1:100 ratio TOP VIEW](#)

[Click to see 1:100 ratio SIDE VIEW](#)



# THE WIZARD'S DOUBLE TOWER FORTRESS

NRO2010

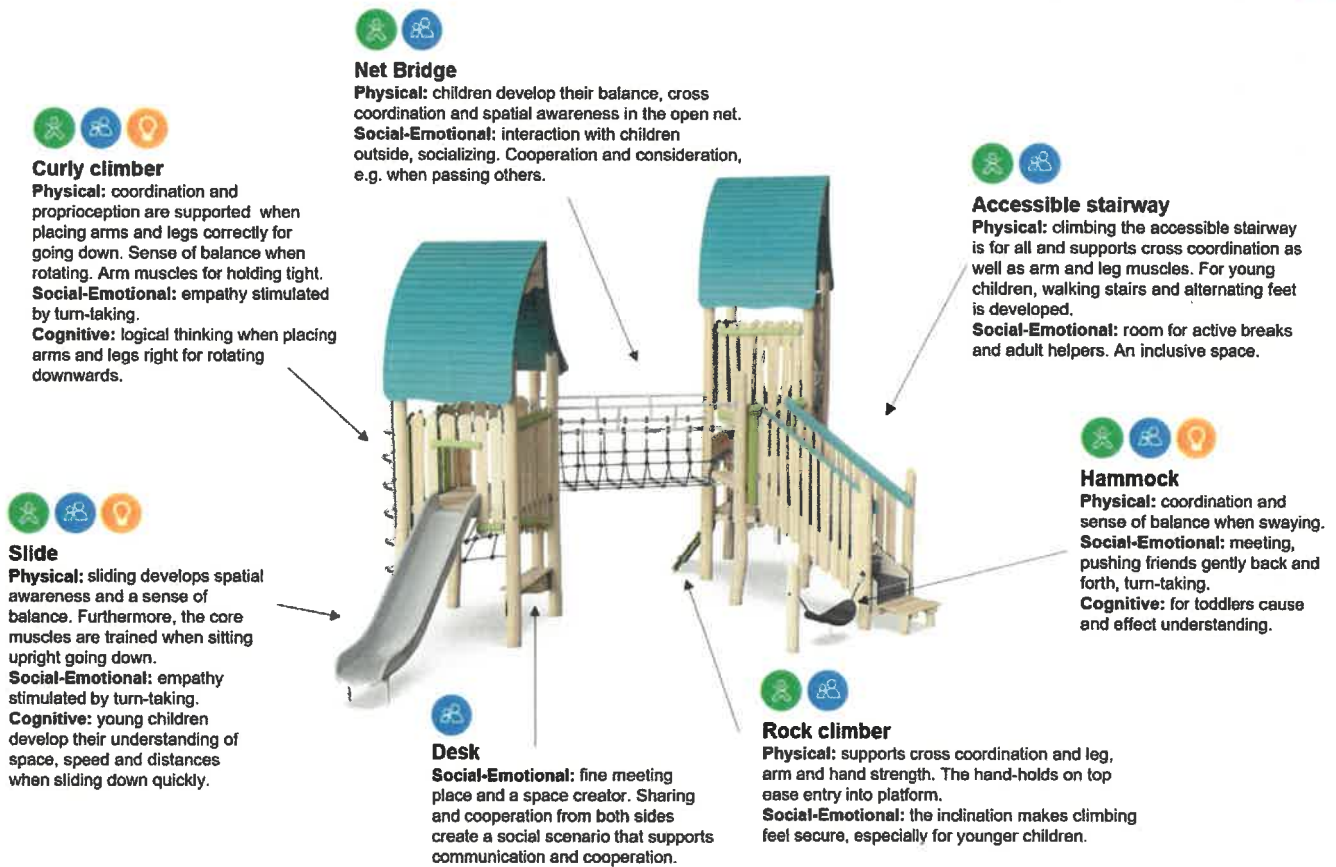

# THE WIZARD'S DOUBLE TOWER FORTRESS



NRO2010



**PHYSICAL**  
Joy of movement:  
motor skills, muscle, cardio  
and bone density



**SOCIAL-EMOTIONAL**  
Joy of being together:  
teamwork, tolerance and  
sense of belonging



**COGNITIVE**  
Joy of learning:  
curiosity, understanding of causal  
relationships and knowledge of the world



**CREATIVE**  
Joy of creating:  
co-creation and experimenting  
with materials



**BALANCE**  
To balance is to stay upright when walking or standing on a surface that makes this challenging (e.g. a wobbly, inclined, or narrow surface).



**HANG IN ARMS**  
To hang in arms is the act of carrying the body with the hands or arms, possibly to traverse to another platform or play item.



**SENSORY**  
To sense is the act of taking in information with the sensory system: seeing, feeling, hearing or sensing with the body.



**BOUNCE**  
To bounce is the act of bouncing on a responsive, flexible, elastic or tensile surface.



**JUMP**  
To jump is the act of jumping up or down on a hard surface.



**SLIDE**  
To slide is the act of moving fast downwards seated on a slide.



**CLIMB**  
To climb is the act of moving upwards, cross-coordinating arms and legs, on a vertical or inclined surface or net.



**PULL**  
To pull is the act of pulling an item towards you or you towards an item with one or both hands, or possibly using the entire body.



**SOCIALIZE**  
To socialize is the act of meeting, communicating or cooperating in an activity that stimulates and facilitates social interaction.



**CONSTRUCT**  
To construct is the act of creating new patterns, shifting items or materials to new positions or constructing with materials that can be transformed or manipulated.



**PUSH**  
To push is the act of pushing an item away from you with one or both hands, possibly with the entire body.



**SPIN**  
To spin involves a fast, repeated horizontal or vertical turn of the body on a piece of equipment that facilitates the movement.



**CRAWL**  
To crawl is the movement of moving forwards or backwards, cross-coordinating arms and legs, on a horizontal or slightly inclined surface.



**ROCK**  
To rock is the action of rocking back and forth, or sideways, on e.g. a piece of spring equipment.



**SWAY**  
To sway is the movement of swaying back and forth, or around, lying, seated or possibly standing, in a pendulant or circular movement, e.g. on a hammock or on a rope.



**DRAMATIC PLAY**  
Dramatic play is motivated through play items that stage a frame, place or environment for acting out make believe or role play scenarios.



**ROTATE**  
To rotate involves a vertical or horizontal slower paced turn of the body, facilitated by a piece of equipment.



**SWING**  
To swing is the movement of swinging back and forth, or in circular movement, seated, standing or lying, in an unhindered arc.



**GLIDE**  
To glide is the act of moving from one point to another without shifting the feet, in a horizontal or vertical movement, in a seated, lying or standing position, letting gravity do the work.



**RULES PLAY**  
Rules play is motivated through play items that suggest games-with-rules, cooperation and team work, e.g. tic-tac-toe, timers or ball games.



**WONDER**  
To wonder is motivated through play items that make children need and use their logical, abstract or creative thinking skills, as well as their memory.

**Option #4: Ranier 5-12 structure: Estimated Price: \$80,900**

*Includes: Equipment, installation, freight, permits, engineered stamped drawings, EWR surfacing, ADA ramp, and borders.*

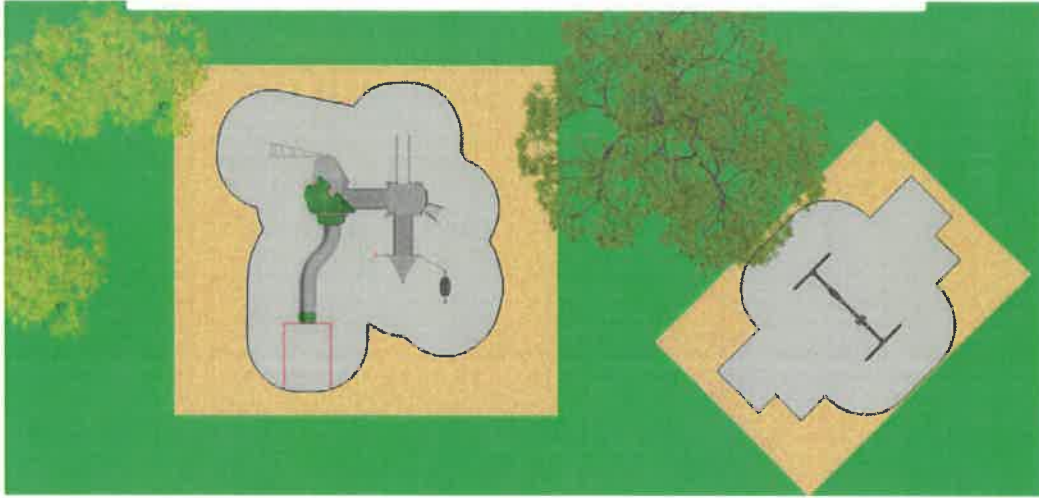





# Rainier

PCE2105



|                                    |                   |
|------------------------------------|-------------------|
| Item no. PCE210500-0902            |                   |
| <b>General Product Information</b> |                   |
| Dimensions LxWxH                   | 21'6"x21'0"x18'9" |
| Age group                          | 5 - 12            |
| Play capacity (users)              | 23                |
| Color options                      |                   |

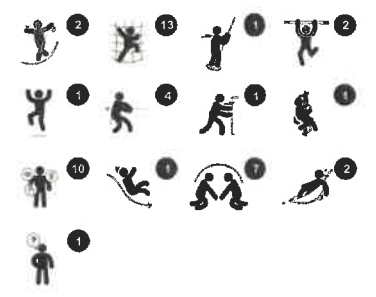

The Rainier, with its impressive height, attracts children again and again. The wide array of fun play activities ensures hours of play. The variety of climbing, sliding, swaying, and sensory play events train cross-body coordination and balance, which are both important for managing traffic safely. The stairway, as well as the sturdy climbing wall

play panels, add an opportunity to take a break on the way up or down, sharing with friends. The play shells and the hammock offer nice, swaying meeting spots. The additional rope ladder and somersault bar add active meeting points. The banister bars and the tall slide are thrilling rewards for the climb up. The Rainier is climbable all over, inside and out, meaning play

opportunities everywhere, for many levels of development. It is a compact play experience for all.



*Data is subject to change without prior notice.*

# Rainier

PCE2105

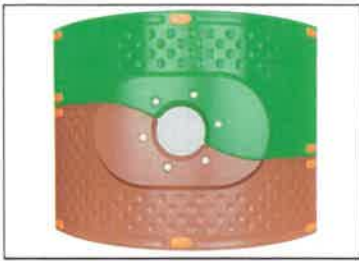

The Curved ELEMENTS panels are molded of UV stabilized recyclable PE with multiple options for in-built play features that also ensures a strong panel solution. Straight panels are made of KOMPAN 19mm PE EcoCore™ which is a highly durable, eco-friendly and recyclable material.



The climbing elements displayed are molded in one piece with a minimum 5mm wall thickness. The climbing elements are made of recyclable PE which has a high impact resistance across a wide temperature span which ensures vandal resistance in all locations.

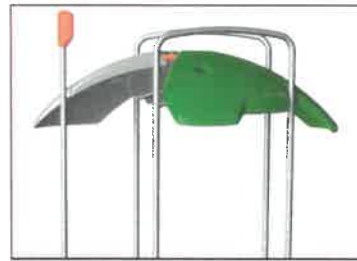

The ELEMENTS roofs are made of recyclable PE with a minimum wall thickness of 5 mm to ensure high durability in all climates around the world. The steel pipes are hot dip galvanized inside and outside for maximum durability.

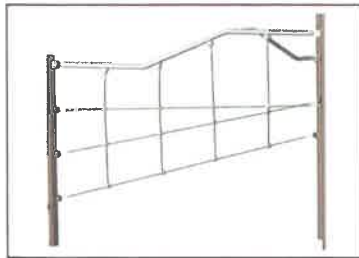

ELEMENTS ropes has six-stranded steel wires and a steel wire core. Each strand is tightly wrapped with PES yarn, which is melted onto each individual strand. After initial friction has removed the surface fibers, a harder PES coating remains to protect each strand, making the ropes highly wear- and vandalism-resistant.



ELEMENTS decks are made of 17.8mm thick HPL supported by a unique designed aluminium frame with multiple attachment options by usage of aluminium connectors. The main posts are made of high quality pre-galvanized steel with powder coated top finish. Post tops are closed with caps of UV stabilized nylon (PA6).

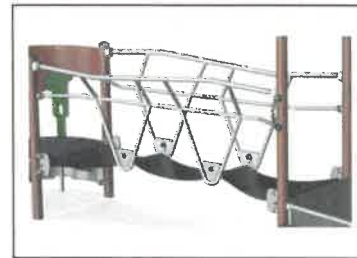

ELEMENTS rubber membranes are conveyor belt made of layers of rubber mixed of natural rubber and SBR rubber, and embedded with layers of armouring made of woven PE and PA. The thickness 8mm ensures high durability in any environment.

Item no. PCE210500-0902

### Installation Information

|                          |  |
|--------------------------|--|
| Max. fall height         | 7'10"  |
| Safety surfacing area    | 876 ft <sup>2</sup>  |
| Number of installers     | 2  |
| Total installation time  | 43.0   |
| Excavation volume        | 1.57 yd <sup>3</sup>   |
| Concrete volume          | 0.14 yd <sup>3</sup>   |
| Footing depth (standard) | 2'9"   |
| Shipment weight          | 2,582 lbs  |
| Anchoring options        | In-ground <input checked="" type="checkbox"/><br>Surface <input checked="" type="checkbox"/> |

### Warranty Information

|                        |          |
|------------------------|----------|
| EcoCore HDPE           | Lifetime |
| Post                   | 10 years |
| Curved Panels          | 10 years |
| Membrane               | 2 years  |
| Spare parts guaranteed | 10 years |

| Elevated activities 6 | Accessible elevated activities | Accessible ground level activities | Accessible ground level play types |
|-----------------------|--------------------------------|------------------------------------|------------------------------------|
| Present               | 4                              | 2                                  | 2                                  |
| Required              | 3                              | 2                                  | 2                                  |

# Rainier

PCE2105



\* Max fall height | \*\* Total height | \*\*\* Safety surfacing area

\* Max fall height | \*\* Total height

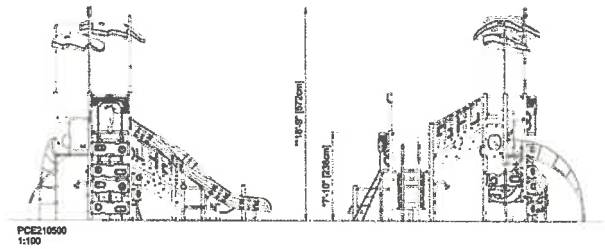
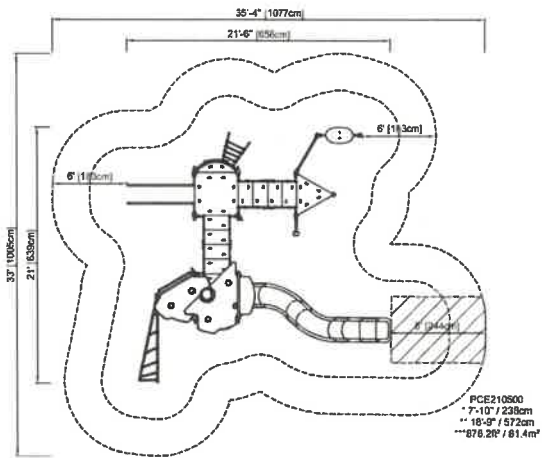

[Click to see 1:100 ratio TOP VIEW](#)

[Click to see 1:100 ratio SIDE VIEW](#)



# Rainier

PCE2105

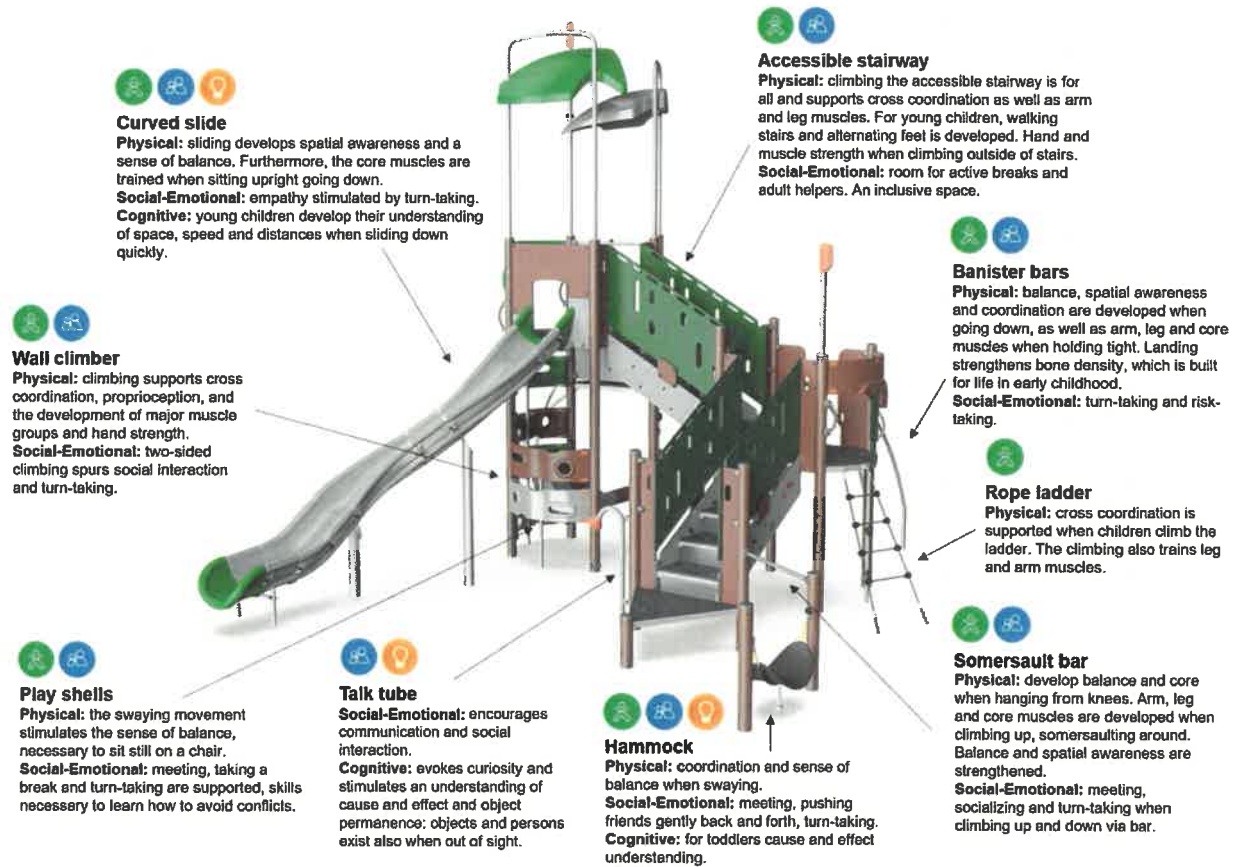

### Curved slide

**Physical:** sliding develops spatial awareness and a sense of balance. Furthermore, the core muscles are trained when sitting upright going down.  
**Social-Emotional:** empathy stimulated by turn-taking.  
**Cognitive:** young children develop their understanding of space, speed and distances when sliding down quickly.



### Wall climber

**Physical:** climbing supports cross coordination, proprioception, and the development of major muscle groups and hand strength.  
**Social-Emotional:** two-sided climbing spurs social interaction and turn-taking.



### Play shells

**Physical:** the swaying movement stimulates the sense of balance, necessary to sit still on a chair.  
**Social-Emotional:** meeting, taking a break and turn-taking are supported, skills necessary to learn how to avoid conflicts.



### Talk tube

**Social-Emotional:** encourages communication and social interaction.  
**Cognitive:** evokes curiosity and stimulates an understanding of cause and effect and object permanence: objects and persons exist also when out of sight.



### Accessible stairway

**Physical:** climbing the accessible stairway is for all and supports cross coordination as well as arm and leg muscles. For young children, walking stairs and alternating feet is developed. Hand and muscle strength when climbing outside of stairs.  
**Social-Emotional:** room for active breaks and adult helpers. An inclusive space.



### Banister bars

**Physical:** balance, spatial awareness and coordination are developed when going down, as well as arm, leg and core muscles when holding tight. Landing strengthens bone density, which is built for life in early childhood.  
**Social-Emotional:** turn-taking and risk-taking.



### Rope ladder

**Physical:** cross coordination is supported when children climb the ladder. The climbing also trains leg and arm muscles.



### Somersault bar

**Physical:** develop balance and core when hanging from knees. Arm, leg and core muscles are developed when climbing up, somersaulting around. Balance and spatial awareness are strengthened.  
**Social-Emotional:** meeting, socializing and turn-taking when climbing up and down via bar.



### Hammock

**Physical:** coordination and sense of balance when swaying.  
**Social-Emotional:** meeting, pushing friends gently back and forth, turn-taking.  
**Cognitive:** for toddlers cause and effect understanding.

# Rainier

PCE2105



**PHYSICAL**  
Joy of movement:  
motor skills, muscle, cardio  
and bone density



**SOCIAL-EMOTIONAL**  
Joy of being together:  
teamwork, tolerance and  
sense of belonging



**COGNITIVE**  
Joy of learning:  
curiosity, understanding of causal  
relationships and knowledge of the world



**CREATIVE**  
Joy of creating:  
co-creation and experimenting  
with materials



**BALANCE**  
To balance is to stay upright when walking or standing on a surface that makes this challenging (e.g. a wobbly, inclined, or narrow surface).



**HANG IN ARMS**  
To hang in arms is the act of carrying the body with the hands or arms, possibly to traverse to another platform or play item.



**SENSORY**  
To sense is the act of taking in information with the sensory system: seeing, feeling, hearing or sensing with the body.



**BOUNCE**  
To bounce is the act of bouncing on a responsive, flexible, elastic or tensile surface.



**JUMP**  
To jump is the act of jumping up or down on a hard surface.



**SLIDE**  
To slide is the act of moving fast downwards seated on a slide.



**CLIMB**  
To climb is the act of moving upwards, cross-coordinating arms and legs, on a vertical or inclined surface or net.



**PULL**  
To pull is the act of pulling an item towards you or you towards an item with one or both hands, or possibly using the entire body.



**SOCIALIZE**  
To socialize is the act of meeting, communicating or cooperating in an activity that stimulates and facilitates social interaction.



**CONSTRUCT**  
To construct is the act of creating new patterns, shifting items or materials to new positions or constructing with materials that can be transformed or manipulated.



**PUSH**  
To push is the act of pushing an item away from you with one or both hands, possibly with the entire body.



**SPIN**  
To spin involves a fast, repeated horizontal or vertical turn of the body on a piece of equipment that facilitates the movement.



**CRAWL**  
To crawl is the movement of moving forwards or backwards, cross-coordinating arms and legs, on a horizontal or slightly inclined surface.



**ROCK**  
To rock is the action of rocking back and forth, or sideways, on e.g. a piece of spring equipment.



**SWAY**  
To sway is the movement of swaying back and forth, or around, lying, seated or possibly standing, in a pendulant or circular movement, e.g. on a hammock or on a rope.



**DRAMATIC PLAY**  
Dramatic play is motivated through play items that stage a frame, place or environment for acting out make believe or role play scenarios.



**ROTATE**  
To rotate involves a vertical or horizontal slower paced turn of the body, facilitated by a piece of equipment.



**SWING**  
To swing is the movement of swinging back and forth, or in circular movement, seated, standing or lying, in an unhindered arc.



**GLIDE**  
To glide is the act of moving from one point to another without shifting the feet, in a horizontal or vertical movement, in a seated, lying or standing position, letting gravity do the work.



**RULES PLAY**  
Rules play is motivated through play items that suggest games-with-rules, cooperation and team work, e.g. tic-tac-toe, timers or ball games.



**WONDER**  
To wonder is motivated through play items that make children need and use their logical, abstract or creative thinking skills, as well as their memory.

# Proposal

Page No. 1 of 3 Pages

## Varsity Courts, Inc.

1970-A CORPORATE SQUARE  
LONGWOOD, FLORIDA 32750  
407-830-8906 • FAX 407-830-7267

|   |               |   |                       |
|---|---------------|---|-----------------------|
| PROPOSAL SUBMITTED TO<br>Town of Windermere           |               | PHONE<br>(407) 595-0196                                 | DATE<br>April 6, 2021 |
| STREET<br>614 Main Street                             |               | JOB NAME<br>Construct two Pickleball Courts             |                       |
| CITY, STATE AND ZIP CODE<br>Windermere, Florida 34786 |               | JOB LOCATION<br>Windermere Rec Center (Butler Bay Park) |                       |
| ARCHITECT<br>Attn: Tracy Mitchell                     | DATE OF PLANS |   | JOB PHONE             |

We hereby submit the following specifications and estimates for:

### **CONSTRUCT TWO (2) PICKLEBALL COURTS – ASPHALT CAP OVER EXISTING PARKING LOT – 60' X 60'**

Varsity Courts, Inc. proposes to apply an asphalt cap to an existing parking lot area to construct two pickleball courts according to the following specifications. All surfacing materials shall be Latex-Ite, manufactured by Dalton Enterprises, Inc. Application of all material shall be done in a workmanlike manner in accordance with the manufacturer's standard specifications.

Clean and install 1" Type III Asphalt compacted finish. Note: Paving over existing concrete the expansion joints can high lite through the asphalt but very minor.

Pavement surface shall be sufficiently cured (approximately 45-60 days depending on weather conditions) and be free of all loose, oily or foreign matter. Prior to the application of the surfacing system, the court surface shall be flooded with water and be allowed to drain. Any depressions holding water deeper than one-eighth inch (1/8") shall be patched using Latex-ite Patch Mix.

#### **FENCING**

Fencing shall be black vinyl mesh, eight foot (8') high. Corner post and gate posts to be 3" OD, line posts to be 2 1/2" OD. All posts to be schedule 40. All posts and framework to be painted to match vinyl mesh, mesh to be 1 3/4", 9 gauge finish with bottom tension wire. Fencing to be held in approximately six inches (6") from paving edge. Two (2) pedestrian gates included. With enough room for a seating area inside fence.

Note: We have in our bid to core drill in the existing concrete, because if we put some in the grass and other in concrete it would be different heights.

**WE PROPOSE** hereby to furnish material and labor - complete in accordance with above specifications, for the sum of:

Payments to be made as specified below: \_\_\_\_\_ dollars (\$ \_\_\_\_\_ )

All material is guaranteed to be as specified. All work to be completed in a workmanlike manner according to standard practices. Any alteration or deviation from above specifications involving extra costs will be executed only upon written orders, and will become an extra charge over and above the estimate. All agreements contingent upon strikes, accidents or delays beyond our control. Owner to carry fire, tornado and other necessary insurance. Our workers are fully covered by Workmen's Compensation Insurance.

Authorized Signature \_\_\_\_\_

Note: This proposal may be withdrawn by us if not accepted within \_\_\_\_\_ days.

**ACCEPTANCE OF PROPOSAL:** The above prices, specifications and conditions are satisfactory and are hereby accepted. You are authorized to do the work as specified. Payment will be made as outlined above.

Signature \_\_\_\_\_

Date of Acceptance: \_\_\_\_\_ Signature \_\_\_\_\_

# Proposal

Page No. 2 of 3 Pages

## Varsity Courts, Inc.

1970-A CORPORATE SQUARE  
LONGWOOD, FLORIDA 32750  
407-830-8906 • FAX 407-830-7267

|   |               |   |                       |
|---|---------------|---|-----------------------|
| PROPOSAL SUBMITTED TO<br>Town of Windermere           |               | PHONE<br>(407) 595-0196                                 | DATE<br>April 6, 2021 |
| STREET<br>614 Main Street                             |               | JOB NAME<br>Construct two Pickleball Courts             |                       |
| CITY, STATE AND ZIP CODE<br>Windermere, Florida 34786 |               | JOB LOCATION<br>Windermere Rec Center (Butler Bay Park) |                       |
| ARCHITECT<br>Attn: Tracy Mitchell                     | DATE OF PLANS |   | JOB PHONE             |

We hereby submit the following specifications and estimates for:

### PICKLEBALL EQUIPMENT

One (1) high quality pickleball net shall be provided and installed. Net posts shall be galvanized steel and powdered painted green and shall be equipped with ratchet-type tightening devices. (Same as tennis court posts but cut down to proper height.) The posts shall be set in sleeves to insure easy removal. Post foundations shall not be less than twenty-four inches (24") in diameter at the top, not less than thirty inches (30") in diameter at the bottom and not less than thirty inches (30") in depth. Center strap and anchor shall be supplied and installed.

### COATING SYSTEM - NOTE: THREE (3) COAT SYSTEM

The entire surface shall receive one (1) coat of Latex-ite Acrylic Surfacer to give texture and safer play

The entire surface shall receive two (2) coats of Latex-ite Acrylic Fortified Color System with sand.

The outside perimeter of asphalt outside of fence will receive one (1) coat of Latex-ite Acrylic Fortified Color System with sand.

Color of court to be TWO TONE GREEN

Playing lines to be striped two inches (2") wide, accurately located using WHITE Latex-ite.

**WE PROPOSE** hereby to furnish material and labor - complete in accordance with above specifications, for the sum of:

\_\_\_\_\_ dollars (\$ \_\_\_\_\_ )

Payments to be made as specified below:

All material is guaranteed to be as specified. All work to be completed in a workmanlike manner according to standard practices. Any alteration or deviation from above specifications involving extra costs will be executed only upon written orders, and will become an extra charge over and above the estimate. All agreements contingent upon strikes, accidents or delays beyond our control. Owner to carry fire, tornado and other necessary insurance. Our workers are fully covered by Workmen's Compensation Insurance.

Authorized  
Signature \_\_\_\_\_

Note: This proposal may be  
withdrawn by us if not accepted within

\_\_\_\_\_ days.

**ACCEPTANCE OF PROPOSAL:** The above prices, specifications and conditions are satisfactory and are hereby accepted. You are authorized to do the work as specified. Payment will be made as outlined above.

Signature \_\_\_\_\_

Date of Acceptance: \_\_\_\_\_

Signature \_\_\_\_\_

# Proposal

Page No. 3 of 3 Pages

## Varsity Courts, Inc.

1970-A CORPORATE SQUARE  
LONGWOOD, FLORIDA 32750  
407-830-8906 • FAX 407-830-7267

|   |               |   |                       |
|---|---------------|---|-----------------------|
| PROPOSAL SUBMITTED TO<br>Town of Windermere           |               | PHONE<br>(407) 595-0196                                 | DATE<br>April 6, 2021 |
| STREET<br>614 Main Street                             |               | JOB NAME<br>Construct two Pickleball Courts             |                       |
| CITY, STATE AND ZIP CODE<br>Windermere, Florida 34786 |               | JOB LOCATION<br>Windermere Rec Center (Butler Bay Park) |                       |
| ARCHITECT<br>Attn: Tracy Mitchell                     | DATE OF PLANS |   | JOB PHONE             |

We hereby submit the following specifications and estimates for:

### OWNER OBLIGATIONS

- Provisions of:  
Power supply to court for construction equipment.  
Water to court necessary for flooding of court and mixing of materials.  
Access road to courtside for trucks and construction equipment.  
Space at court area for storage of materials.
- All zoning laws to be followed and permits obtained prior to start of construction.

**ALL MATERIALS AND WORKMANSHIP HAVE A FULL ONE YEAR WARRANTY**  
**NOTE: NO WARRANTY ON CRACKS: NEW OR REOCCURRING**

**PER THE US TENNIS COURT AND TRACK BUILDERS ASSOCIATION PLEASE NOTE "WHENEVER REPAIR, RESURFACING OR OVERLAY IS CHOSEN, IT IS IMPORTANT FOR AN OWNER TO REALIZE THAT CRACKS ALWAYS RE-APPEAR".**

**WE PROPOSE** hereby to furnish material and labor - complete in accordance with above specifications, for the sum of:

Nineteen Thousand Seven Hundred Thirty Seven \_\_\_\_\_ dollars (\$ \$19,737.00 )

Payments to be made as specified below:

80% Upon completion of paving, 10% upon completion of fencing, 10% upon completion of job.

All material is guaranteed to be as specified. All work to be completed in a workmanlike manner according to standard practices. Any alteration or deviation from above specifications involving extra costs will be executed only upon written orders, and will become an extra charge over and above the estimate. All agreements contingent upon strikes, accidents or delays beyond our control. Owner to carry fire, tornado and other necessary insurance. Our workers are fully covered by Workmen's Compensation Insurance.

Authorized  
Signature

*Dennis Brubach*

Note: This proposal may be withdrawn by us if not accepted within 30 days.

**ACCEPTANCE OF PROPOSAL:** The above prices, specifications and conditions are satisfactory and are hereby accepted. You are authorized to do the work as specified. Payment will be made as outlined above.

Signature \_\_\_\_\_

Date of Acceptance: \_\_\_\_\_

Signature \_\_\_\_\_



**Estimator: Chris Tappan**

## **PICKLEBALL PROPOSAL**

Submitted To:

May 7, 2021

Town of Windermere

RE: Main Street Pickleball Courts

520 Main Street

Windermere, FL 34786

---

*Monthly progress payments based on schedule of values. Price subject to change after 45 days. Our Base Price to furnish materials and labor as outlined:*

**Two Pickleball Court Construction Price: \$48,565.00**

---

### **SCOPE OF WORK:**

- 1) Mobilization.
- 2) Site Prep:
  - a. **Trees to be removed by Owner prior to our arrival.**
  - b. Remove and dispose of existing sport courts and loose material.
  - c. Rework existing subgrade and compact.
  - d. Subgrade to be 0.83% to 1.00% slope towards one side of court.
- 3) Furnish and Install 6" of Limerock; laser grade and compact.
- 4) Pave 1 1/2" of SP 9.5 RAP Asphalt on court. Approximate Paved Area: 60' x 60'
- 5) Furnish and Install two (2) new sets of black semi-permanent pickleball posts and nets complete with footings and sleeves.
- 6) Flood courts and patch any areas holding water per ASBA and USTA guidelines.
- 7) Apply two (2) coats of Acrylic Resurfacer over the entire surface of the court.
- 8) Apply two (2) coats of Color Coating over the entire surface of the court:
  - a. Inbounds Color: TBD Standard Color
  - b. Outbounds Color: TBD Standard Color
- 9) Paint regulation pickleball court markings with white textured line paint.
- 10) Install approximately 240 LF of 8' high black fencing set into asphalt court complete with powder-coated framework and two (2) gates.

### **NOTES:**

- 1) Water must be allowed to drain from court surface. Do not block water flow on side of court with grass or landscaping.
- 2) Owner to provide suitable access for equipment, water, and electric as required.
- 3) Should owner request additional material applied or other work performed to the surface of court which is not outlined above, it will be at an extra cost.
- 4) **EXCLUSIONS:** Survey, permits, mass excavation of fill, testing, erosion control, sodding, tree & landscape removal, curb, trench drains, irrigation, relocation of utilities, shade structures, sidewalks, benches, court lighting, or conduit.

**CRACKS IN PICKLEBALL COURTS:**

It should be noted that as your pickleball court ages, it will develop cracks. Cracks develop in tennis courts for various reasons with the most common being:

- 1) Constant expansion and contraction of more than 7,000 square feet of surface per court in response to constant fluctuations in ambient temperatures. These daily fluctuations are often greatest in winter.
- 2) Loss of flexibility of the asphalt as it ages and loses the oils used in the manufacturing process.
- 5) Changes in subsurface stability reflecting through the court surface.

Nidy does **NOT** provide any written or implied guarantee of pickleball courts being free from cracks; thus, cannot and does not warrant against cracks appearing after the court has been surfaced.

**WARRANTY:**

Color Coating is warranted against any excessive fading for a period of one year from application. Surface is warranted against peeling and flaking for a period of one year from application. Problems from normal wear, vandalism, and improper care are excluded.

Owner's Name & Billing Address: \_\_\_\_\_

Job Site's Contact Name & Phone: \_\_\_\_\_

Job Site's Address: \_\_\_\_\_

\_\_\_\_\_  
Authorized Signature

\_\_\_\_\_  
Total Dollar Amount Authorized

\_\_\_\_\_  
Date



7011 Wilson Rd.  
WPB FL. 33413  
561-964-2001 Fax: 561-964-5009  
[www.sportsurfaces.com](http://www.sportsurfaces.com)

April 13, 2021

Attn: Tonya Elliott Moore

Town of Windermere

Windemere Rec Center - Butler Bay Park  
11465 Park Avenue  
Windermere, FL

Dear Tonya,

Thank you for interest in Sport Surfaces to build two pickleball courts.

Here at Sports Surfaces, we believe that the key to successful business is having the right product/service at the right time, offering the best quality for the lowest price. We back this up with a two-year warranty unlike most of our competitors who only offer a one-year warranty. We are continually striving to be the most innovative, creative, service minded company in the tennis industry.

We have over 100 years of combined experience and our highly skilled technicians are trained to perform all phases of athletic court construction, resurfacing and maintenance.

Sports Surfaces has installed top quality athletic courts right in your neighborhood and all over the world. Our Company has a long list of satisfied customers ranging from Estee Lauder's Residence to top seeded players.

In addition we carry a full line of sport court equipment, accessories and lighting products

Please let us know if you have any questions or comments. For more detailed information about our services and products, please visit our web page at [www.sportsurfaces.com](http://www.sportsurfaces.com)

We look forward to hearing from you and the possibility of doing business with you. Our reputation and work history guarantee you have made the right decision.

Sincerely,

*Sheila Dobbins*

Sales Estimator - Sport Surfaces LLC.





7011 Wilson Rd.  
WPB FL. 33413  
561-964-2001 Fax: 561-964-5009  
www.sportsurfaces.com

## PROPOSAL/AGREEMENT

April 13, 2021

Town of Windermere

Windermere Rec Center - Butler Bay Park  
11465 Park Avenue  
Windermere, FL

Agreement made between Sports Surfaces LLC. hereinafter called the Contractor and Town of Windermere, hereinafter called the Customer for the construction of (2) pickleball courts with respect to the following terms and specifications:

### PAVING for Hard Court

Asphalt Paving (up to 7200 sf)

The Contractor will excavate and remove dirt as necessary and move to customers dumpster or designated area.

The Contractor will apply 6" of lime rock or crushed concrete compacted to approximately 4".

The Contractor will apply SIII compacted to 1".

### COURT PREPARATION: Area to be approximately: 60' X 120'

The Contractor will pressure clean and power blow court(s) as necessary to remove loose dirt, mildew and oil.

The Contractor will patch depressions greater than 1/8" after 1 hour drying time in sunlight, grind down any ridges as necessary and fill existing cracks as best as possible prior to surfacing.

Note: court must have a minimum of 1% slope in one plane in order to guarantee removal of water.

The Contractor will install (2) pairs of pickleball posts.

The Contractor will supply and install (2) pickleball nets.

### SURFACING OF 2 PICKLEBALL COURT(S)

The Contractor will apply (2) Coat of Acrylic Resurfacer over entire court area to fill voids and provide smooth surface.

The Contractor will apply (2) Coats of Acrylic Color Concentrate (two-tone), To provide in depth color over court surface.

Inner court color choice \_\_\_\_\_ Outer court color choice \_\_\_\_\_

(Colors may be selected by visiting [www.sportmaster.net](http://www.sportmaster.net) and following the Court Designer link)

The Contractor will accurately locate, mark, and paint two- inch wide pickleball playing lines in accordance with U.S.T.A. regulations.

using white textured heavy bodied acrylic latex paint.

The Contractor shall thoroughly and expediently clean up all drums, trash, etc. upon job completion.

### PROVISIONS

The Customer agrees to pay a 33% due upon acceptance of proposal.

The Customer agrees to pay a 33% deposit upon installation of rock.

The Customer agrees to pay balance upon completion of the above-proposed work.



7011 Wilson Rd.  
WPB Fl. 33413  
561-964-2001 Fax: 561-964-5009  
www.sportsurfaces.com

April 13, 2021

Town of Windermere

Windermere Rec Center - Butler Bay Park  
11465 Park Avenue  
Windermere, FL

**Privacy / Terms and Conditions Policy:**

CUSTOMER AGREES THAT BY SIGNING THE BELOW CONTRACT THEY AGREE TO ABIDE BY OUR PRIVACY / TERMS AND CONDITIONS WHICH CAN BE FOUND BE FOUND ON OUR WEBSITE: <https://sportsurfaces.com/terms-and-conditions/>

**CREDIT**

If the Customer does not pay as agreed upon, the Contractor shall have the right to file a lien against the real estate for the amount of the work done. No further work shall be accomplished if installment payments are not made at the time specified. In the event it is necessary to employ the services of an attorney to secure payment, as per the terms of this agreement, then the customer agrees to pay reasonable attorney fees. Interest of 1 ½ % per month will be charged on accounts past due.

**GUARANTEE**

The Contractor guarantees all work against defects in workmanship or materials for a **period of (2) years** from date of completion. This guarantee excludes Normal wear and tear, physical abuse or neglect and any other conditions beyond the contractor’s control, such as sub-base settling, structural cracks, asphalt shrinkage cracks, hydrostatic pressure or water vapor pressure bubbles, intrusion of weeds or grass, etc. Existing cracks may reappear at any time. Proper tennis shoes must be worn on court. Some sneakers, street shoes, dark soled shoes, skateboards, roller blades, etc. will scuff and damage surface. Guarantee shall become void upon owner’s failure to adhere and comply with the payment schedule.

**FEE**

The Contractor agrees to provide tools, materials, labor, supervision and insurance to complete the above work for a sum of

**\*\*\*\*THIRTY- NINE THOUSAND AND SIX HUNDRED DOLLARS (\$39,600.00) \*\*\*\***

*\*All prices are in US Dollars. Prices are subject to change after ninety days. Our bid prices are based upon you providing adequate access and storage.*

Respectfully submitted by: *Sheila Dobbins*

Sales Estimator - Sport Surfaces LLC.

Proposal accepted by: \_\_\_\_\_ Title: \_\_\_\_\_ Date: \_\_\_\_\_

# TOTAL BRICK PAVERS

5130 Old Winter Garden Rd.  
Orlando, FL 32811

Phone: 407-298-1324 Fax: 407-296-7815

|   |                                    |
|---|------------------------------------|
| <b>Project Name:</b><br>RECREATION CENTER   | <b>Date:</b><br>4/5/2021           |
| <b>Project Address:</b><br>11465 PARK AVE.<br>WINDERMERE, FL 34786                                | <b>Cell:</b><br>321-388-5048       |
| <b>Phone #:</b> 321-299-2409  | <b>Bill to:</b> TOWN OF WINDERMERE |
| <b>Fax #:</b>   | 614 MAIN STREET                    |
| <b>e-mail:</b> <a href="mailto:tmathias@town.windermere.fl.us">tmathias@town.windermere.fl.us</a> | WINDERMERE, FL 34786               |

## Scope of Work:

|   | Sq. Ft       | Total              |
|---|--------------|--------------------|
| Install Pavers Walkway - Tennis Court Area  | 470          | \$ 3,854.00        |
| Include: Concrete Fines, Sand, Concrete Locking Edge Band, Cement, Pavers Material, Delivery and Labor. |              |                    |
| City of Windermere will responsible to excavate and grading the paver area.                             |              |                    |
| Price Based OldCastle Coastal Pavers Selection.   |              |                    |
| Color: Slate - Gray Cement Color Selection  |              |                    |
| Shape: Appian Stone 6x6 & 6x9   |              |                    |
| Pattern: Same Existing Pattern  |              |                    |
|   | <b>Total</b> | <b>\$ 3,854.00</b> |

\*Total Brick Pavers, Inc. will furnish & supply sand, labor and material to complete this job as specified in the original contract

\* Please be aware that you may receive a "Notice to Owner" from Total Brick Pavers, Inc. and/or its suppliers.

\*It is the responsibility of the homeowner or contractor to provide a base 5 1/2"-6" below final grade.

\*Total Brick Pavers, Inc. will not be responsible for damage to concrete, tile, sod, irrigation, landscaping, underground utilities or anything not specified in this contract.

\*Should there be any dispute following project, customer will be responsible for all attorney fees.

\*It is the responsibility of the homeowner or contractor to pull any permits required in the municipality of job.

\*Any changes beyond this contract will be for materials and labor plus shipping and/or restocking fees.

\*Any unused material at completion of job is property of Total Brick Pavers.

\*One-year warranty provided on labor.

\_\_\_\_\_  
Total Brick Pavers

Date: \_\_\_\_\_

\_\_\_\_\_  
Date: \_\_\_\_\_

Proposal

# ACCURATE

PAVERS &  
LANDSCAPING

Rodney  
321-229-4878

210 E. Sandpiper St  
Apopka, FL 32712

email: accuratepaversland@yahoo.com

|                          |                    |               |                |           |                              |
|--------------------------|--------------------|---------------|----------------|-----------|------------------------------|
| Proposal Submitted To    | Joan of Windermere | Phone         | (321) 289-2410 | Date      | 9-3-01                       |
| Street                   | 11465 Park Ave     | Job Name      | Tennis Ct.     |           |                              |
| City, State and Zip Code | Windermere FL      | Job Location  | Tony's Home    | Job Phone |                              |
| Estimator                | Lochay             | Date of Plans |                |           | Tmoore@accn.windermere-fl.us |

We hereby submit specifications and estimates for:

Paver: Install 495 sqft pavers w/ 130 wast.  
 Install crushed concrete base + concrete border  
Color: Slate  
Type: 6x6/6x9 vappah stone combo  
Pattern: Existing pattern  
 1 yr warranty on workmanship

\$3217.50

**Accurate Proposal** Hereby to furnish material and labor — complete in accordance with above specifications for the sum of:  
 2 thousand 200 complete dollars (\$ \_\_\_\_\_)

Payment to be made as follows:

All Sales are final no guarantee. All material is guaranteed to be as specified. All work to be completed in a workmanlike manner according to our standard practices. All agreements contingent upon strikes, accidents or delays beyond our control. Owner to carry fire, tornado and other necessary insurance. Our workers are fully covered by Workman's Compensation Insurance. Price shown hereon does not include state sales tax. That will be added to final bill. In the event of any dispute hereon, the prevailing party shall be entitled to reimbursement for it's reasonable attorney's fees, interest and costs through all appeals and collection efforts. (18% interest; 30 days)

Authorized Signature \_\_\_\_\_

Note: This proposal may be withdrawn by us if not accepted within \_\_\_\_\_ days  
 Company is not responsible for any unseen objects underground, such as cable and/or phone lines and septic tanks.

**Acceptance of Proposal** - The above prices, specifications and conditions are satisfactory and are hereby accepted. You are authorized to do the work as specified. Payment will be made as outlined above.  
 Date of Acceptance \_\_\_\_\_

Signature \_\_\_\_\_  
 Signature \_\_\_\_\_

**Town of Windermere  
Parks and Recreation Committee  
Proposed Meeting Minutes  
April 7, 2021**

**Members Present:** Doug Bowman, Nora Brophy, Shery Cassidy, Dena O' Malley, Tracy Mitchell, Cindy Hunter

**Others Present:** George Poelker, Curt Frazier, Tonya Elliott-Moore

**Call to Order:** The meeting was called to order by Nora Brophy. She noted that a quorum was present to approve official business.

**Business Agenda**

**Old Business/Events**

- A. Windermere Petfest – Nora commented that she'll be looking to pick a date for next year's event very soon
- B. 19<sup>th</sup> Annual Run Among the Lakes – Nora indicated that a note is going out to prospective sponsors for the October 16, 2021 event. She noted that Town Council member Bill Martini is helping with the 2021 shirt designs. Nora also mentioned that she does need a volunteer for help with advertising placement, and to contact her for that.
- C. Tennis – The committee discussed progress on several court maintenance issues. These included painting the Main Street backboard, new scorecards added for all courts, and the large dying tree removal at WRC causing court issues. Items still TBD include research on self-locking court gates, fence repairs, and the suggested security camera. Tonya Elliott-Moore indicated that a new paver connector path from sidewalk over to courts at WRC would run approximately \$3850. Dena suggested to add more permanent tennis signage by the courts instead of the laminated messaging now there.
- D. Windermere Rec Center – Nora indicated that measurements have been taken along with spacing demands for the proposed playground equipment at WRC. \$3850 has been approved for the playground equipment with the whole project cost estimate around \$40,000. Nora noted that the committee is waiting on the safety fencing estimate for the perimeter around the playground equipment.

The committee discussed the Main Street tennis resurfacing and pickleball court estimates provided by a local vendor. A motion was made and seconded to put out both bid requests, and for the pickleball courts proposed scope of work not to exceed \$25,000. The committee asked that these 2 bids be put out as soon as possible with the hope of Main Street resurfacing starting in August or September.

- E. Kayak/Canoe Storage – Discussion ensued around this topic. The consensus of the group is that WRC is the best initial location for this amenity. This

matter should continue to move forward with more research conducted for pricing.

- F. Doggy Dooleys – These were approved by the Town Manager for all parks.

**New Business**

- A. Boathouses – Curt Frazier and George Poelker made guest resident comments regarding the existing Windermere boathouse history and situation. Leases on the boathouses expire in July 2021. The committee discussed the request to make a recommendation to Tow Council on future use for the boathouses and some rough awards process. After some discussion, the committee consensus is/was to create a multi year lottery system to award boathouse use as the fairest way to involve residents in an equitable use process.
- B. Meeting minutes from both the March 11, 2021 regular meeting and the April 1, 2021 special Fernwood Park meeting were approved by the committee
- C. Liaison Reports – No Liaison was present to present a report.
- D. Adjournment – The meeting was adjourned at approximately 6:00 p.m. The next regular meeting is scheduled for Thursday, May 13th at 5:00 p.m. in Town Hall.